

INSTALLATION INSTRUCTIONS

HTR-P-RANXD-ID: RANGER XD 1500 HEATER KIT

⚠ Please look through and read these instructions BEFORE starting so you understand what processes you'll be doing, and possible extra tools you may need.

⚠ Do Not discard product packaging until installation is complete and functioning properly.

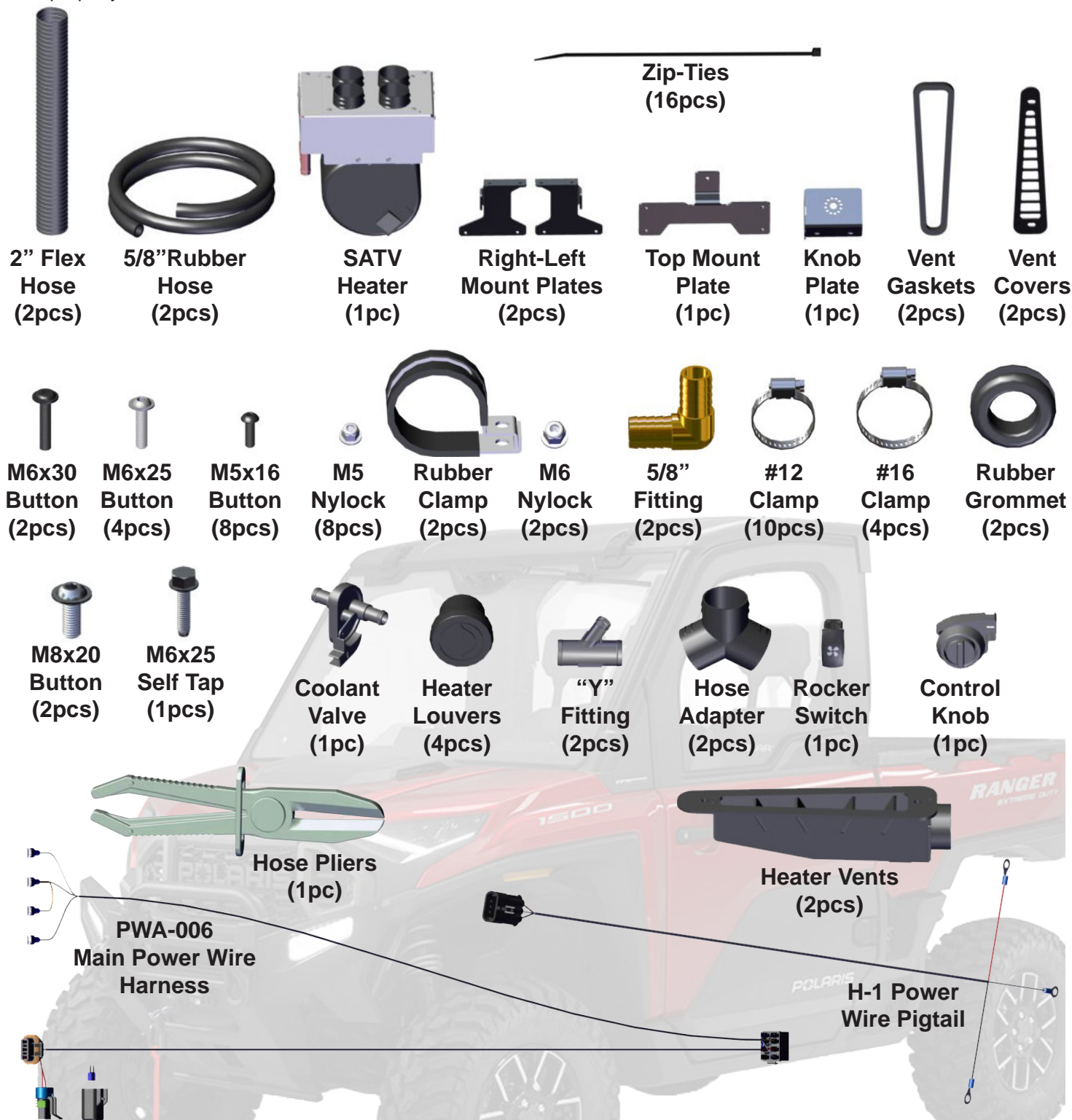

1. The first thing is to **Remove** the **Hood** for access up front. See **Fig.1a**. Then you will need to remove items inside the cab area. Next, remove the **Gauge Cluster Cover Panel** as shown in **Fig.1b-c**. After that, then **Remove** the **Round Vent Inserts** from the dash. There are Four (4) of them as shown in **Fig.1d**. And then remove the Long Factory Vent Covers, one on each side. See **Fig.1e**.



Fig.1a



Fig.1b



Fig.1c



Fig.1d



Fig.1d

2.Next, you can **Remove** the **Guage Cluster** Unit by first **Removing** the plastic **Cover**. **Remove** the **Push-Pins** as shown in **Fig.2a** then remove Cover as shown in **Fig.2b**.



Fig.2a



Fig.2b

3.Now **Remove** the **Guage Cluster** and **Unplug** the Connector on the back as show in **Fig.3**.

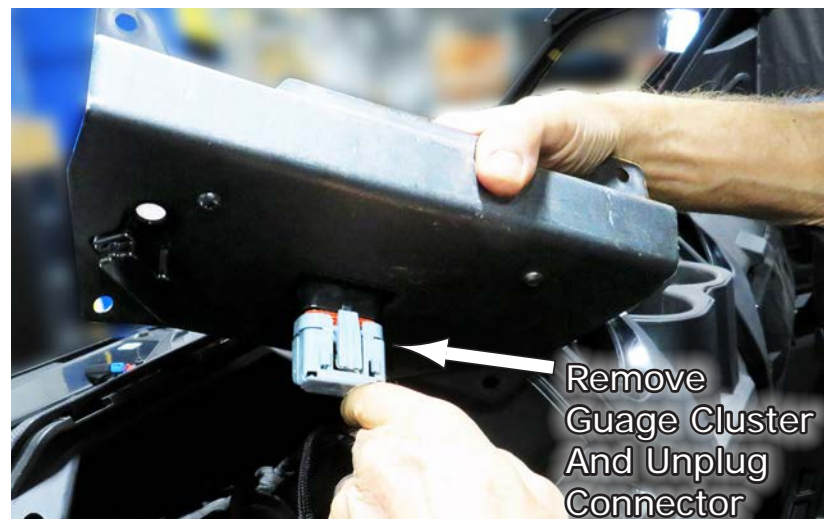

Fig.3

4.Next, you will **Remove** the **Side Dash Panel** by **popping** it off and then **Remove** the **Connectors** as shown in **Fig.4a-b**.



Fig.4a



Fig.4b

5.Next, you will **Remove the Small Center Dash Panel** by **Removing the Two (2) Push-Pins** along the bottom edge of the panel as shown in **Fig.5a-b**.



Fig.5a



Fig.5b

6.Now **Remove the Two (2) Torx Screws** as shown in **Fig.6a-b**.



Fig.6a



Fig.6b

7.Then **Remove the Rubber Dash Covers** as shown in **Fig.7a-b**, Then **Remove the Torx Screws** underneath the Covers from the dash.

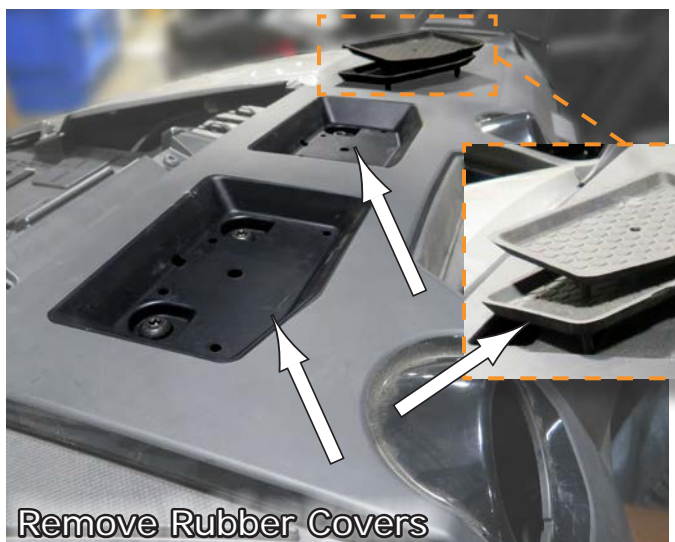

Fig.7a



Fig.7b

8. Now, **Remove the Main Center Dash Panel** exposing inside the dash as shown in **Fig.8a-b**.

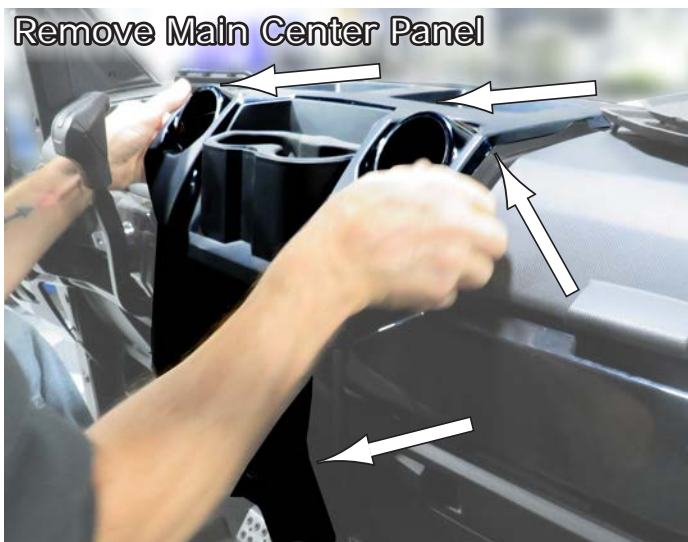

Fig.8a



Fig.8b

9. After the panel is removed, **Remove any Factory Vent Hoses** to clear for access. See **Fig.9a-b**.

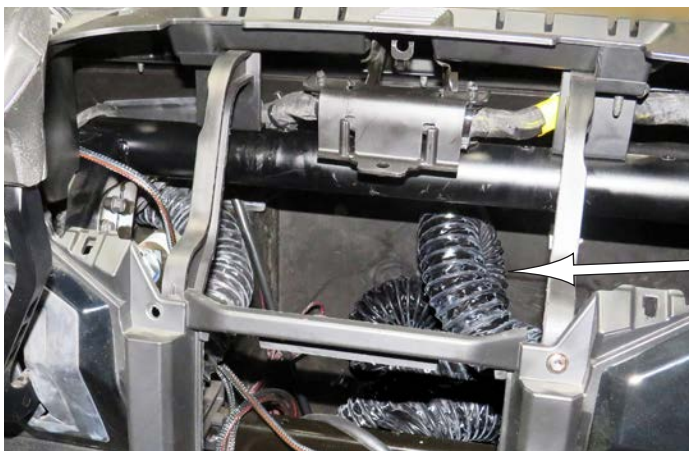

Fig.9a



Fig.9b

10. Now you can start to **Run the Cable Harness**. One end will go to the Switch, One to the Power Supply and the Terminal Ends will go to the Blower Motor in the next steps. So start to **Feed the Switch Connector** end thru the middle and down towards the front dash Panel (where it was removed) and **Pull the Switch Connector Out** as shown in **Fig.10a-b**, and let it hang for now.



Fig.10a



Fig.10b

11. Next, route the Power Cable portion of the Harness down and Forward Thru Firewall Access as shown in **Fig.11a**. Then from the front of the vehicle, pull the Power Connector end out as shown in **Fig.11b**. Next find the power bar on the firewall and remove one of the Dummy Plugs and connect your Power Connector into that slot to power the heater system. See **Fig.11c**.



Fig.11a

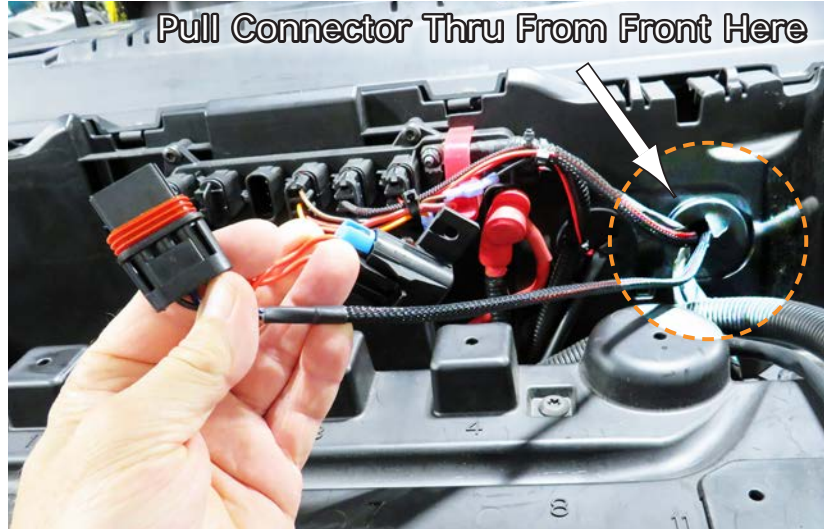

Fig.11b

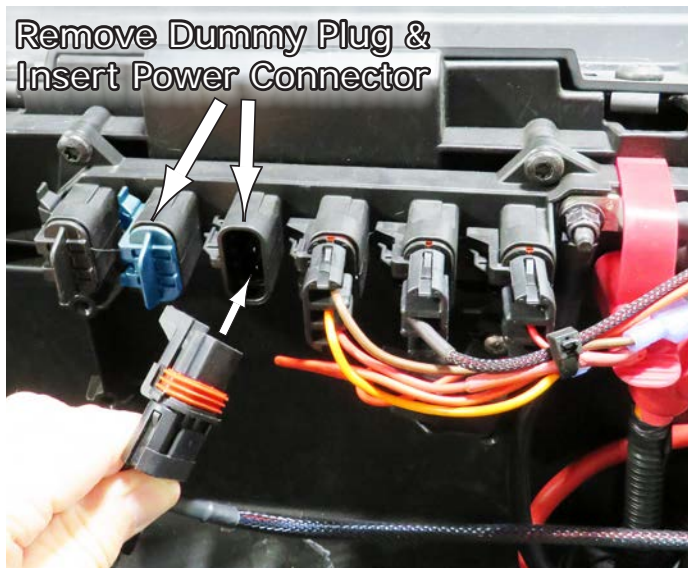

Fig.11c



Fig.11d

12. The next thing to do is you will need to **Drill (2) 1-1/4" dia. Holes, 2" Apart, Center to Center.** Fig.12 shows them drilled complete. Location is behind the shock spring Front Right Wheel Well. See below.



Fig.12

13. Now, you need to make a hose assembly. Your kit has Two (2) hose sections. Take one of the hose sections from your kit and **Cut** it in half. Then take one of those halves and cut a piece **At 13-1/2" Long**. This will be the hose section installed on the **Left** shown in **Fig.13**. Left of the Coolant Valve. The **Remaining Piece** will be the hose section installed on the **Right** side of the Coolant Valve assembly also shown in **Fig.13**. The other "Half" of that hose will be used as is in the following steps. Leaving you another hose section still in your kit.



Fig.13

14. You will assemble the Two (2) hose pieces to the Coolant Valve as shown in **Fig.14**. Notice the orientation of the Coolant Valve in relationship to the hose lengths. Use the Hose Clamps provided but do not tighten down yet as you may need to adjust the hoses when installing it into the vehicle. See **Fig.14**.



Fig.14

15. Then **Install** the **Wire Cable** into the **Coolant Valve Tab**. Be sure to feed it in from the "Left Side" of the Tab as shown in **Fig.15a-b**. Then take the **Wire Cable Clip** and snap it onto the Coolant Valve to hold the wire cable snug against the valve, also shown in **Fig.15a-b**.

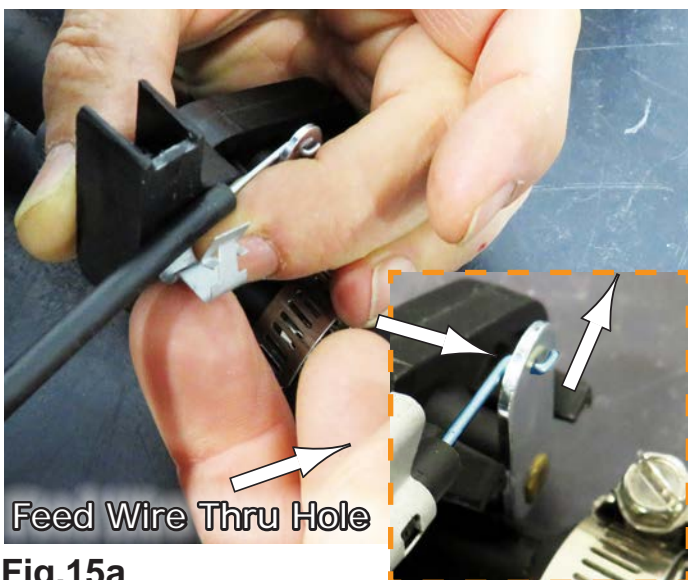

Fig.15a



Fig.15b

16. Now go back to the holes you just drilled for the hoses and **Insert the Rubber Grommets** into those holes as shown in **Fig.16a-b**. **NOTE: If needed, you can remove the Shock to give more clearance to get the correct drilling angle if needed for Grommet Holes.**



Fig.16a



Fig.16b

17. Next, from the front area under the hood, insert the **Green Hose End** thru the **Grommet**. This is the end on the same side as the Wire Cable attached to the Colant Valve. Then run the **Blue Hose Half** thru the **Bottom Grommet** as shown in **Fig.17a-b**. Then pull the other end of the Coolant Valve hose assembly up thru the center dash area shown in **Fig.17b**.

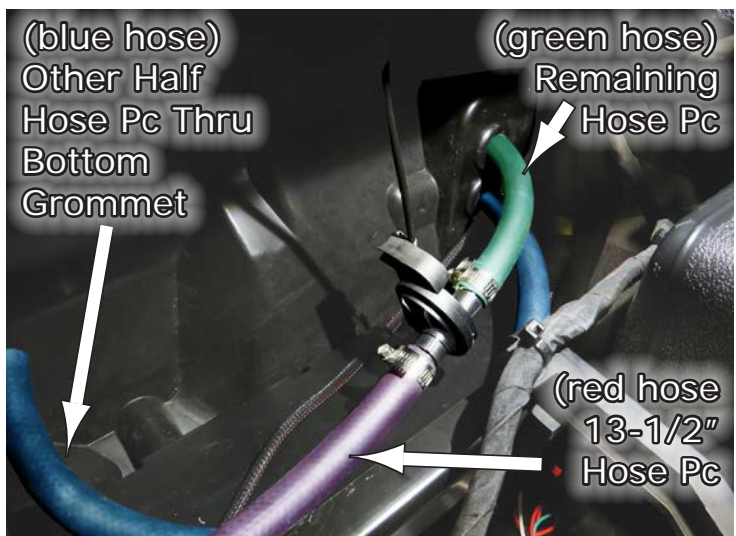

Fig.17a

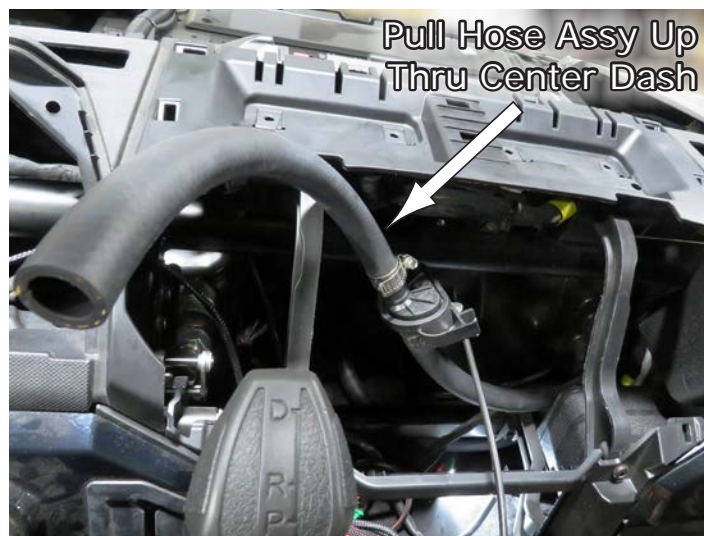

Fig.17b

NOTE: Be sure your hose assembly looks like the one in Fig.17c and that the Coolant Valve is facing the same direction so that the Hot Temp Control is Hot when set to Hot and not Cold when set to Hot.



Fig.17c

18. Now you need to allow more room when installing the Blower Motor Thru the dash area. So you need to remove the Lower screw from the center dash area as shown in **Fig.18**, so that both top and bottom screws are removed. This will allow you to pull that section of panel out giving you space to work etc. See **Fig.18**.

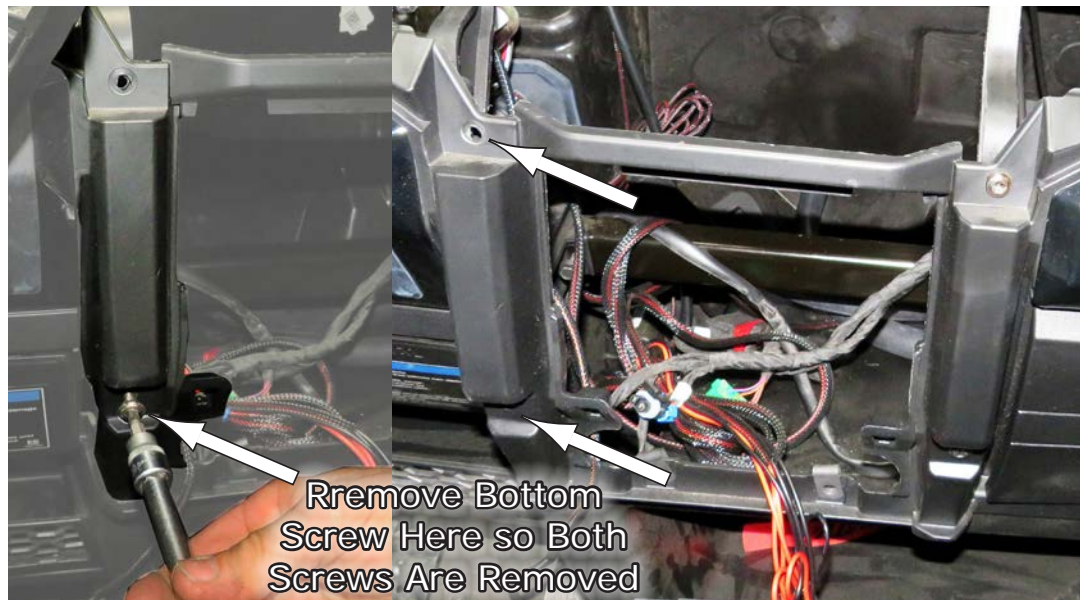

Fig.18

19. Next, find the **Left, Right and Top Mounting Plates** in your kit as you will need to assemble them to the **Blower Motor**. Assemble using the **M5x16 Button Head Screws** and **M5 Nylock Nuts** as shown in **Fig.19a-b**. **Fig.19b** shows the mounting plates installed onto the motor.

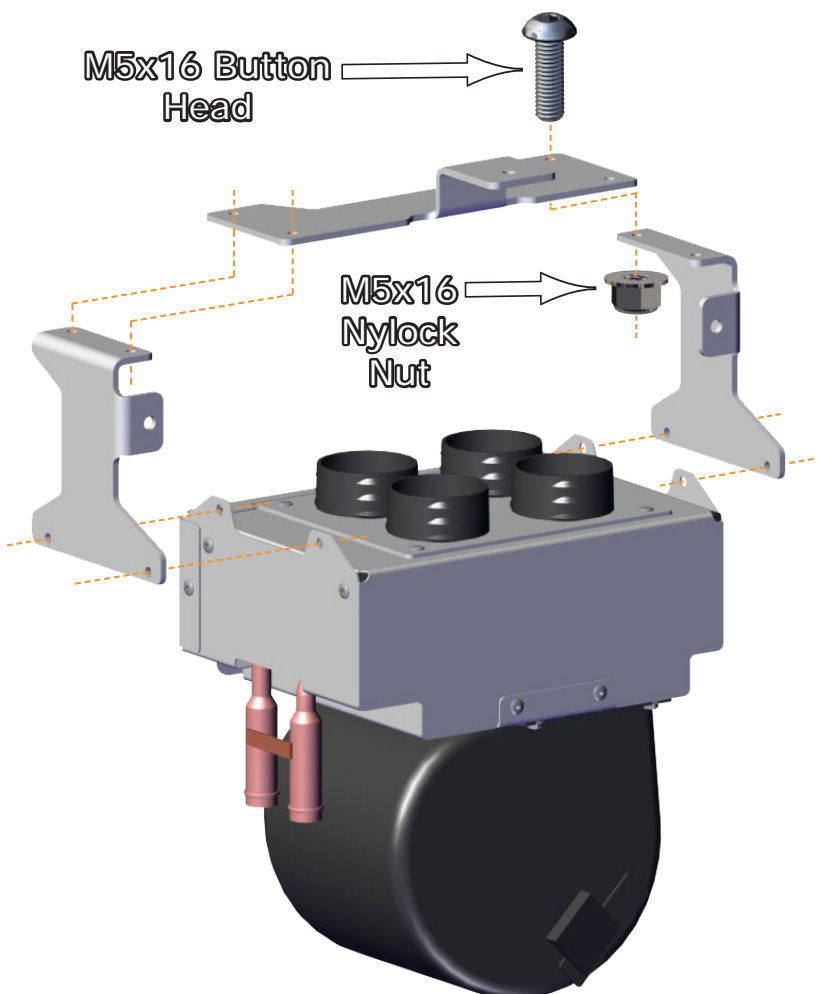

Fig.19a



Fig.19b

20. Once the brackets are on the motor, you can now drop it down inside the center dash area as shown in **Fig.20a-b**. Make sure it is in the same position and orientation as the one shown in **Fig.2b** before proceeding.

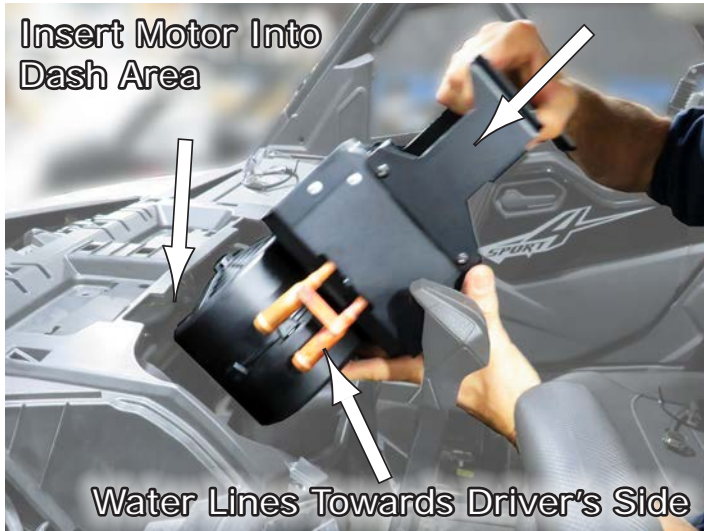

Fig.20a

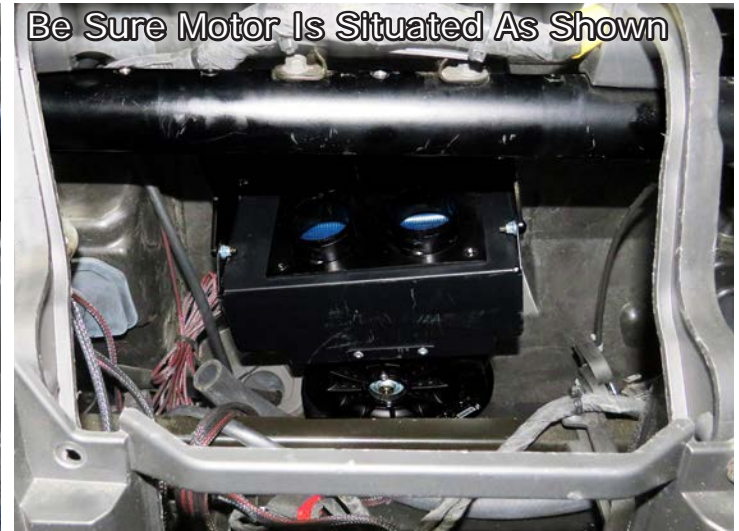

Fig.20b



21. Now you will be tapping a hole to mount the Blower Motor to. It is located right in the middle of the round tube bar going across and above the motor you just put in. **Fig.21a** shows the location. You will then need to pull the wrapped bundle of wires towards you that is most likely tied to the hanging bracket there to expose the existing hole as shown in **Fig.21b**. Use the **M6x25 Self Tap Bolt** in your kit and thread it down into the hole to tap it to that bolt size, and remove it, ready to mount the motor.



Fig.21a



Fig.21b

22. Then **Hang** the **Blower Motor** hanging the top mount bracket over the top of the tube, then install the **M6x25 Self Tap Bolt**, but do not tighten until all motor mounts are threaded in place and after any adjustments needed. See **Fig.22a-b**.

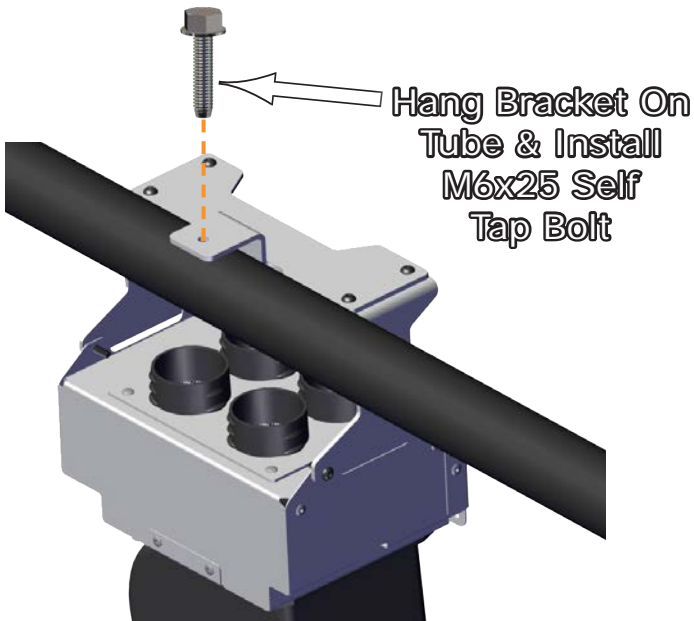

Fig.22a



Fig.22b

23. Next you will need to hook up the upper heater ductwork. These first Two (2) will route to the furthest vents closest to the doors. One on each side. So you will cut two (2) Vent Hoses, one (1) at **40"** and one (1) at **36"**. The 40" one goes to the Driver's Side Vent which we'll do first. So cut the 40" long vent tube first. Then slide one end over the **left rear vent port** on the blower as shown in **Fig.23a**. Then route the other end over to the round vent by the Drive's Door and out that vent. Then slide the tube over the Heater Louver Inner half and zip tie if needed, **Fig.23b**, and set it back into the vent space as shown in **Fig.23c**. Then Screw in the Louver Vent Cover, as shown in **Fig.23d**.

NOTE: When hooking the vent tubes to the blower, it may be easier to install by removing the Self-Tap Bolt and lowering the motor down for a little more access if needed.



Fig.23a



Fig.23b



Fig.23c



Fig.23d

24. Now take the **36"** Vent Hose for the **Passenger's Side Vent**. Slide it over the Rear Right Port on the blower, route to the Passenger's Heat Vent and install same as Driver's side. See **Fig.24a-b**.



Fig.24a



Fig.24b

25. After the right Heater Louver is installed, now we can **Secure** the **Blower Motor** to the frame. To do this find the **Two (2) Rubber Clamps** in your kit. Then notice the **Two (2) Bracket Flanges** on the front of the Blower as shown in **Fig.25a**. This is where you will attach them to. Now loop the Rubber Clamps around the Tube frame making sure they are in the same orientation facing the same way as the ones shown in **Fig.25b**. Then **Secure** the **Clamps** to the frame using the **Two (2) M6x30 Button Head Screws** and **M6 Nylock Nuts** provided in your kit. See **Fig.25c-e**.

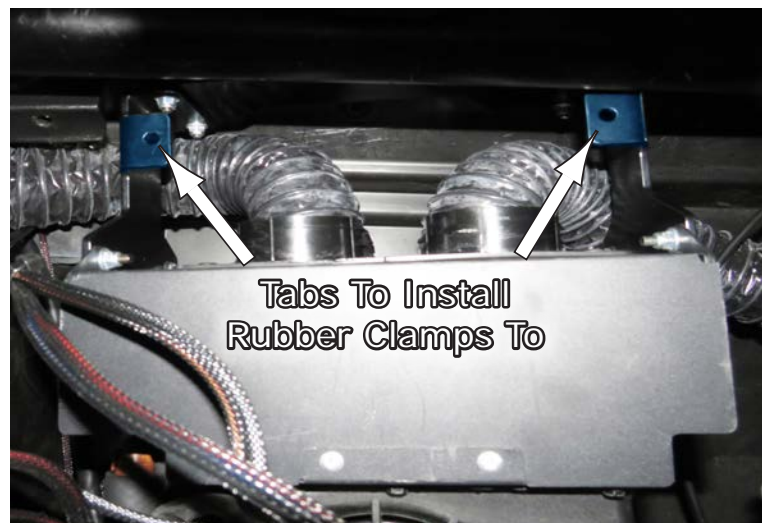

Fig.25a



Fig.25b

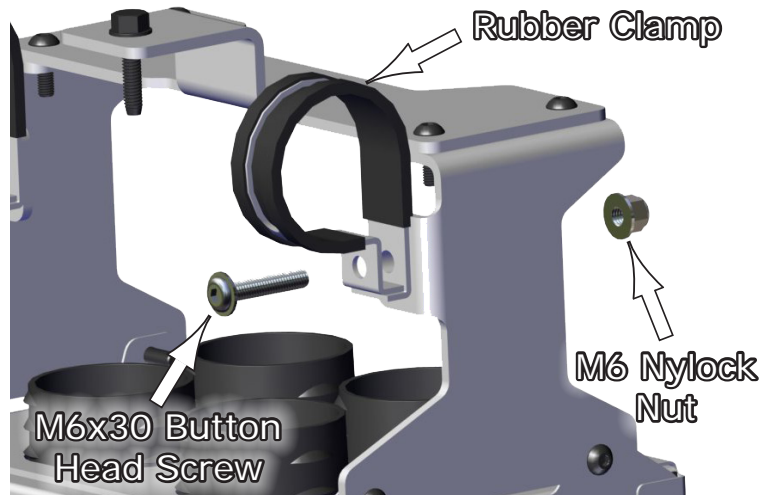

Fig.25c



Fig.25d

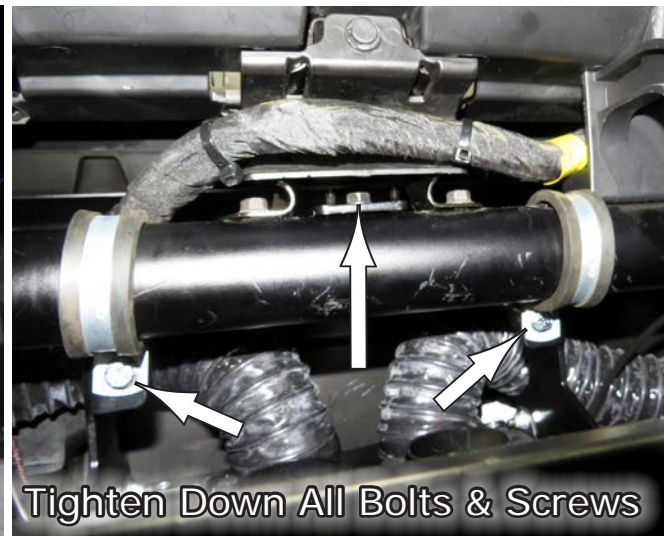

Fig.25e

NOTE: When tightening down screws, be sure to leave a little gap between the Motor and the Frame to keep from rubbing as shown below.



26.Next, **Reinstall** the **Push-Pin** to secure the hanging bracket as shown in **Fig.26a-b**.



Fig.26a



Fig.26b

27.Now **Reinstall** the **Screws** to attach the panel frame in the **Upper Location** behind the Tube Frame as shown in **Fig.27a**, then the **Middle Location**, **Fig.27b** and **Lower Location** as shown in **Fig.27c**.

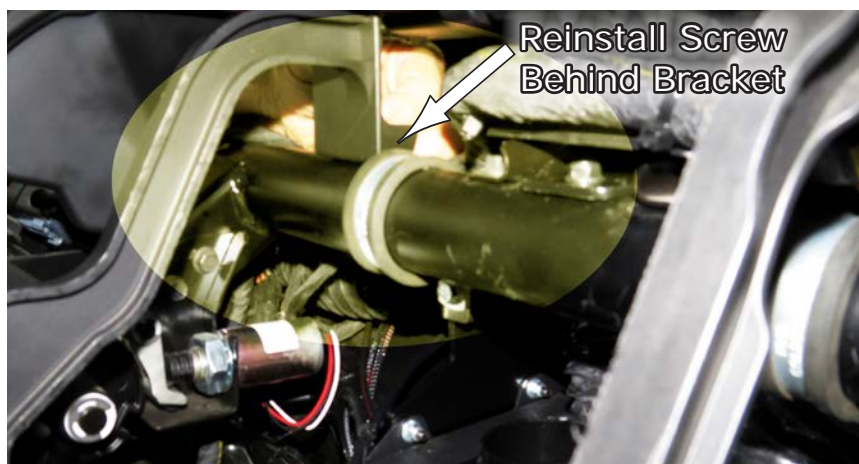

Fig.27a



Fig.27b



Fig.27c

28. Next, you can hook up the water lines to the blower. Connect the Top Line with the Coolant Valve connected to it to the copper fitting closest to the front of the vehicle. This is the line using the “**Dashed Line**”. Then connect the lower line coming thru the firewall to the copper fitting closest to you. This is the line using the “**Dotted Line**” in the illustration below. See **Fig.28**.

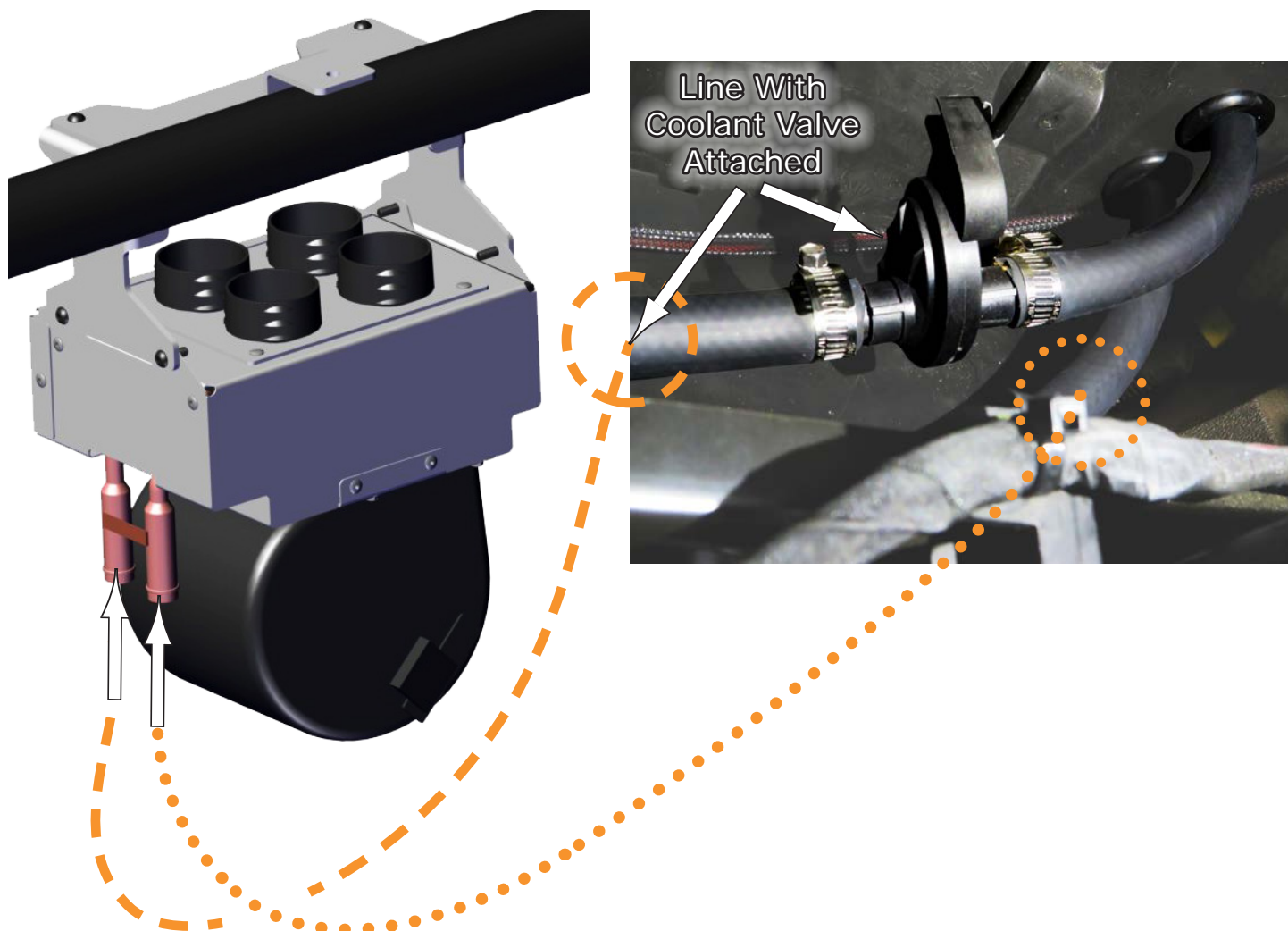

Fig.28



29. Slide the hose ends over the **Copper Fittings** and use the **Small Band Clamps** to tighten the hose down to the fittings as shown in **Fig.29**.

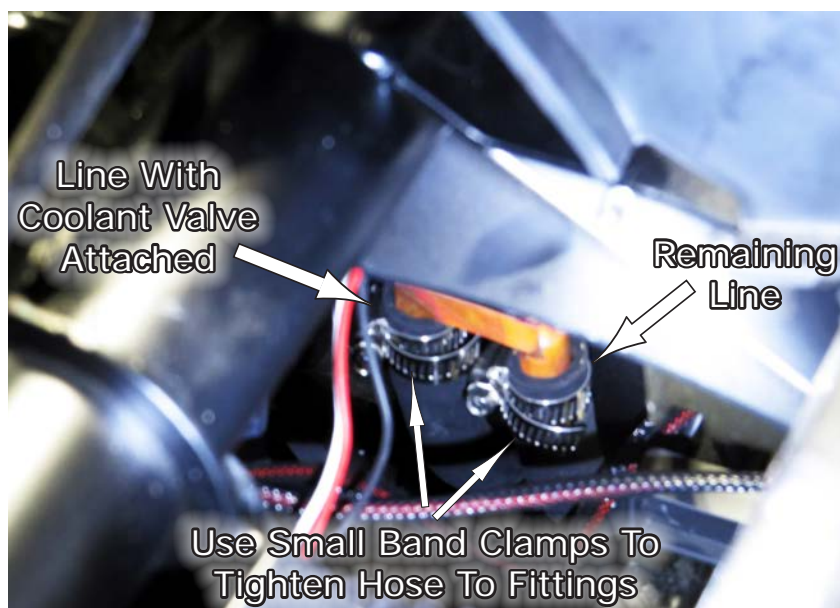

Fig.29

30. After the water lines are connected to the blower, you can now start to install the heater defrost vents and louvers. To do this you will need to pre-assemble Two (2) small assemblies first. **Fig.30a** shows the two assemblies complete ready to install.



Fig.30a

We will make one set at a time. First you need to **Cut Three (3) pcs of Vent Tubing** for the Left or Driver's Side Assembly. **You need: (1) Cut at 16", (1) at 12", (1) at 20" long.** Then find one of the **3-Way Hose Adapters**, the **Heater Vent** and **Heater Vent Adhesive Backed Foam Seal**. **Fig.30b** shows the Heater Vent and Adhesive Backed Foam Seal. Take the center foam out of the Seal, peel the adhesive backing off and apply it to the flat face of the vent as shown in **Fig.30b**.

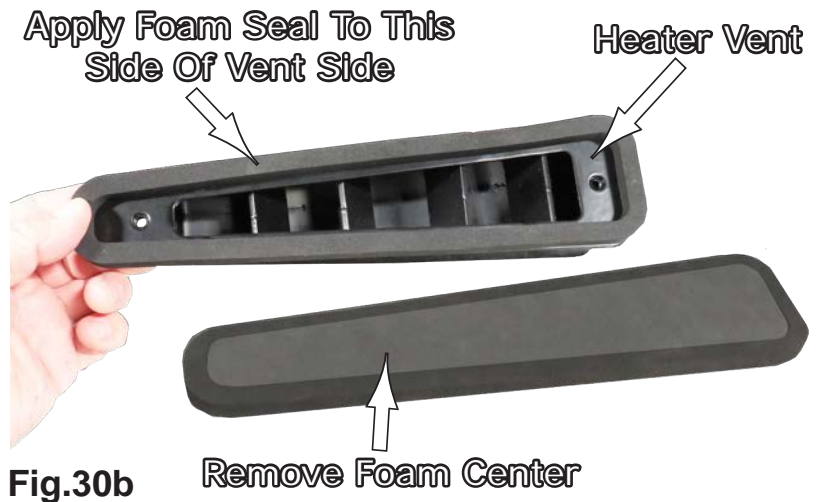
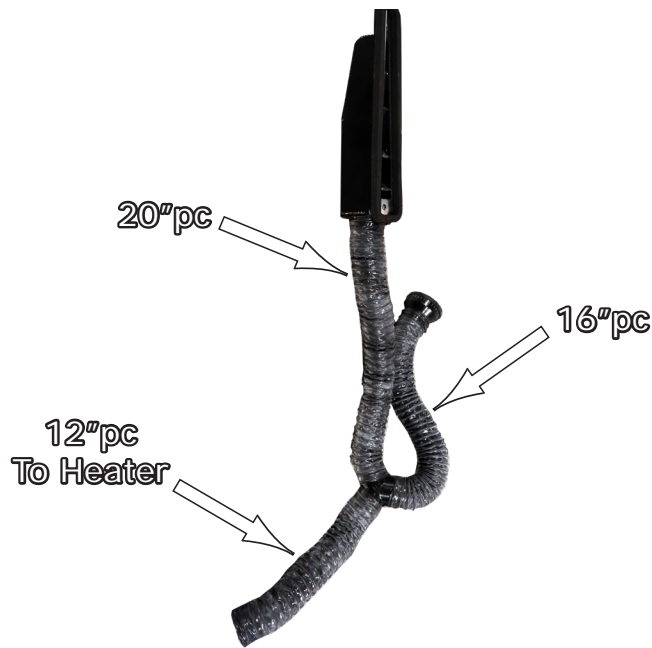
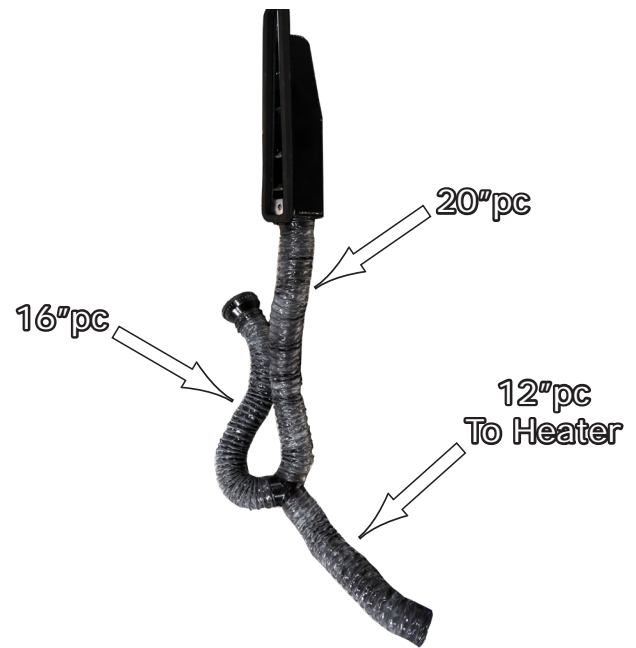

Fig.30b

Driver's Side Assembly



Passenger's Side Assembly



31. When building the vent hose assemblies, slide the tubing over the Adapter ends and Zip-Tie to secure them to the adapter as shown in **Fig.31a**. The same with installing the Heater Louvers to the tubing. Zip-Tie to secure to the Adapter. See **Fig.31b**.

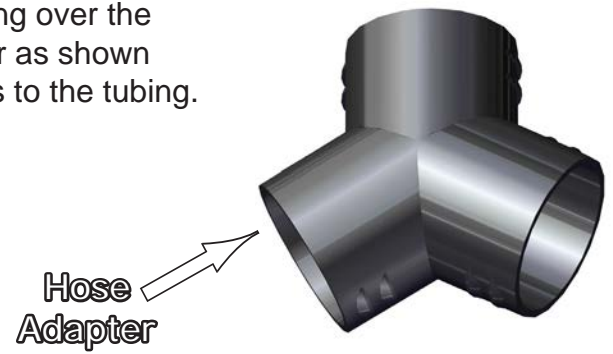

Fig.31a



Fig.31b



32. Now take the Driver's Side Assembly and start feeding it in thru the center dash area going towards the defrost vent in front of the steering wheel as shown in **Fig.32a-c**.



Fig.32a



Fig.32b

33. After getting the Vent up and in place, press the Foam Seal up against the underside of the dash and then install the Vent Cover using the **M6x25 Button Head Screws** provided in your kit. See **Fig.33a-b**.

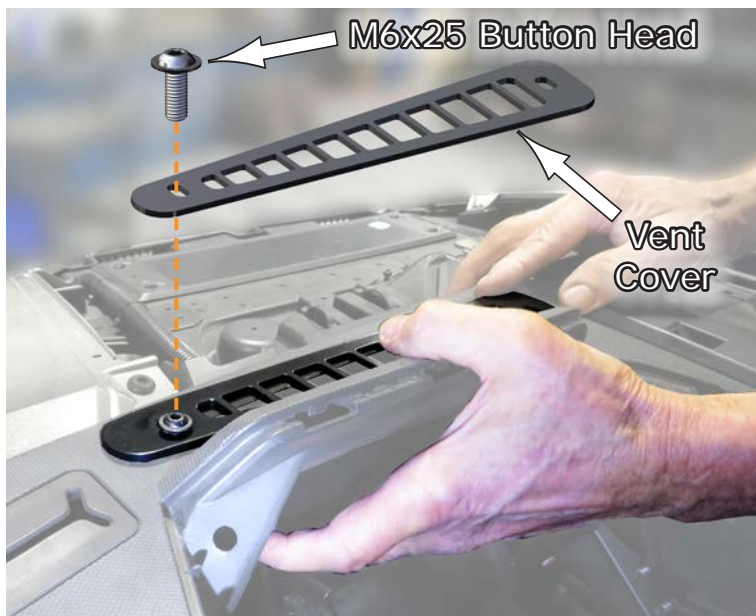

Fig.33a



Fig.33b

34. After securing the defrost vent, the remaining assembly should look like **Fig.34a**. Then Hook up the remaining vent hose to the Front Left Port on the Heater Blower as shown in **Fig.34b**.



Fig.34a



Fig.34b

35. Install the Right or Passenger's side Vent assembly the same as the left side and attach the remaining hose to the Front Right Port of the blower as shown in **Fig.35a-b**.



Fig.35a



Fig.35b

36.Next you need to install the **Control Knob/Switch**. To do that you need to first **Drill a 1/2" Dia. Hole, 7/8" in** from both corner edges as shown in **Fig.36a-b**.



Fig.36a



Fig.36b



37.Now find the **Control Knob/Switch** and **Control Plate** in your kit. Then attach the Switch to the Plate using the supplied **Bezel** and **Nut** then secure tight. See **Fig.37a-b**.



Fig.37a



Fig.37b

38.Next, **Install the Control Switch** into the console panel and slide it over to the right side where you drilled the 1/2" Dia. hole at. See **Fig.38a-b**.

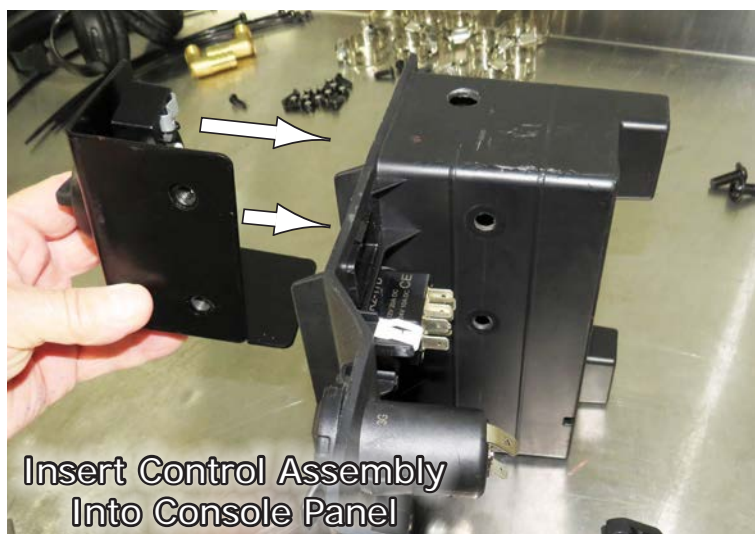

Fig.38a

Fig.38b

39.Then mark the Two (2) Holes to drill thru where your Bolts will secure the Switch to. See **Fig.39a-b**. Drill Thru using an 8mm Bit.

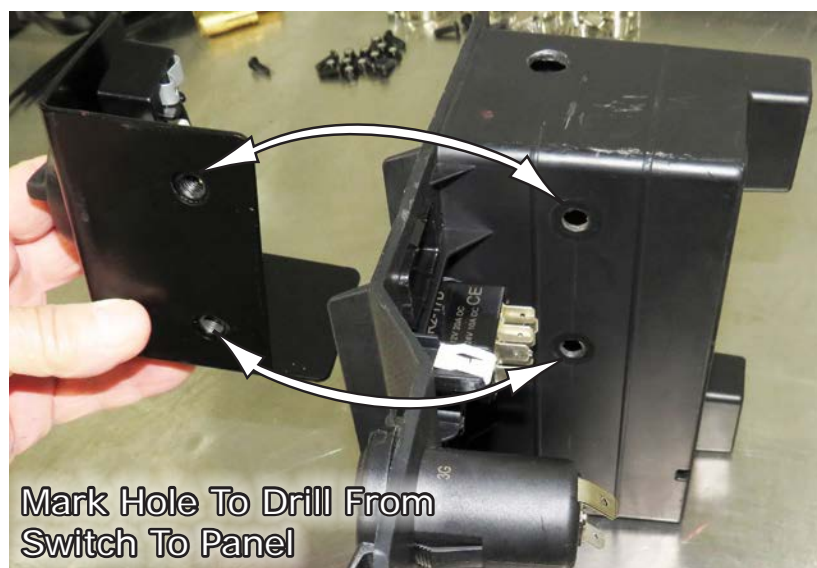

Fig.39a

Fig.39b



40.The next thing is to **Install the Center Dash Panel Vent Louvers** as shown in **Fig.40**.



Fig.40

41. Then take the vent tubes and feed them through the vent holes as shown in **Fig.41a-b**. Then **Install the Vent Louvers** onto the ends of them and replace panel back onto the vehicle as shown in **Fig.41c**.

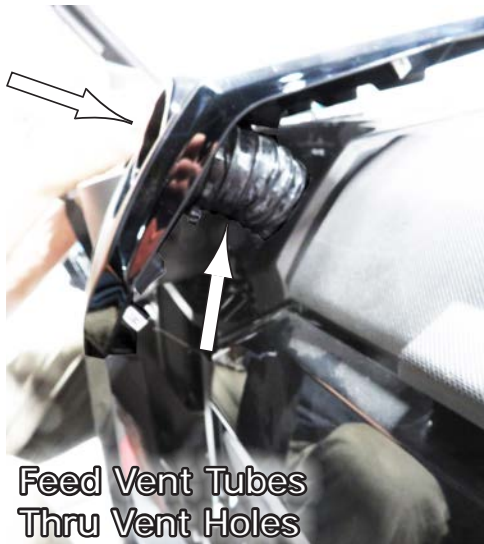

Fig.41a



Fig.41b



Fig.41c

42. Next, we'll **Hook-up the Wire Cable End** to the **Control Knob Assembly**. First pull the Wire Cable out the center a little and find the Switch Box you drilled the hole in the side of as shown in **Fig.42a**. Now before you finish the wire, while you are there, connect the power harness connectors together as shown in **Fig.42b**.

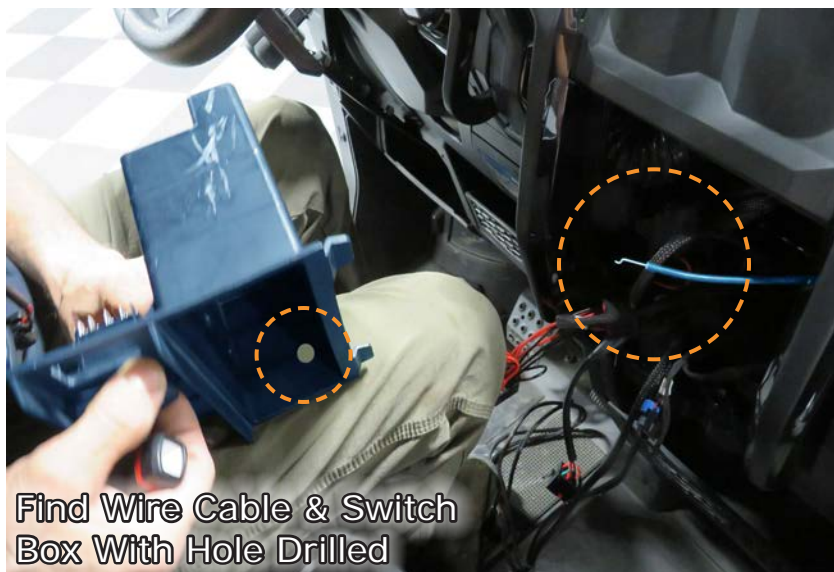

Fig.42a



Fig.42b

43. Then feed the Wire Cable thru the hole in the side of the box that you drilled. Now find the Control Switch Assembly and feed the bent end of the wire thru the little hole in the tab of the Control Valve as shown in **Fig.43a-b**.



Fig.43a

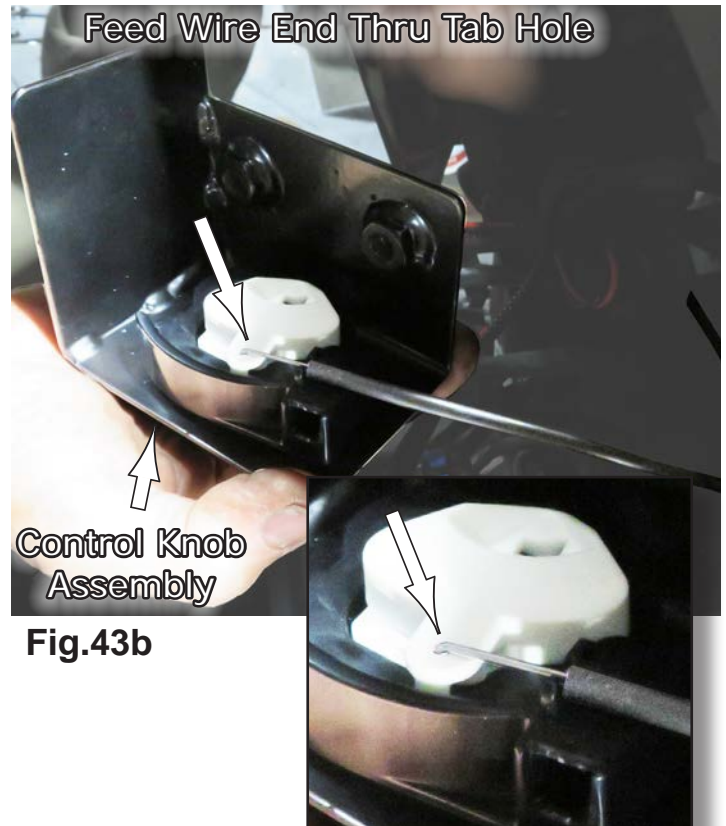

Fig.43b



44. Once the Wire End is seated in the Tab, then find the **Cable Clip** and clip the cable to the Switch Body holding firm against the switch as shown in **Fig.44a-b**.



Fig.44a



Fig.44b

45. Now you can screw the Control Switch Assembly to the box using the **M8x20 Button Head Screws** provided in your kit. Then just let that panel rest on the floor for now. See **Fig.45a**. Then take the large dash panel and put it back in place on the vehicle and screw all factory screws, Push-Pins or other required to secure it back on the vehicle. See **Fig.45b**.

Install Switch Assembly To Box
Using M8x20 Button Head Screws

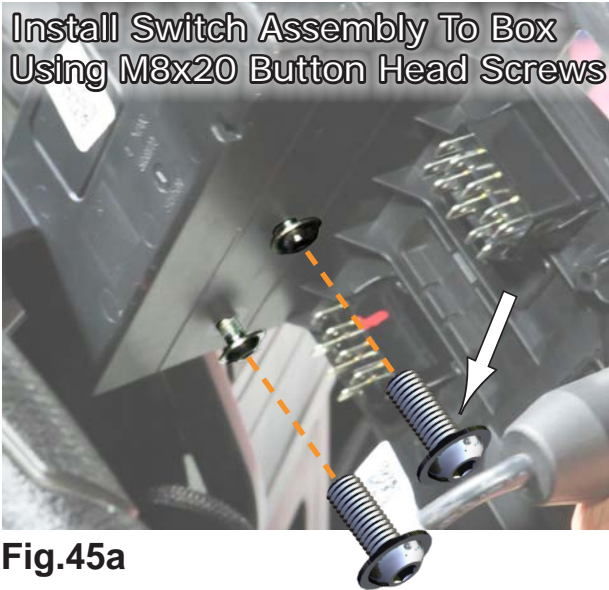

Fig.45a



Fig.45b



46. Now install top dash and all other screws previously removed to secure dash. See **Fig.46a**. Then reconnect all connector plugs into the back of the small center panel that has the Control Switch/ Knob Assembly in it, and any other that needs to be reconnected as shown in **Fig.46b**.

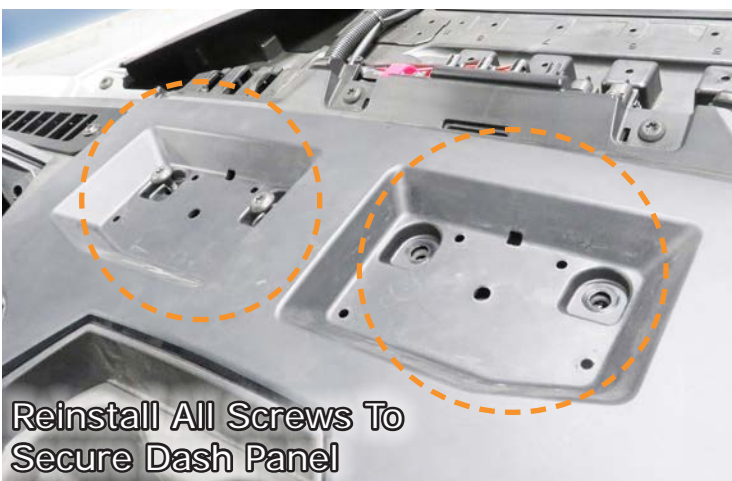

Reinstall All Screws To
Secure Dash Panel

Fig.46a

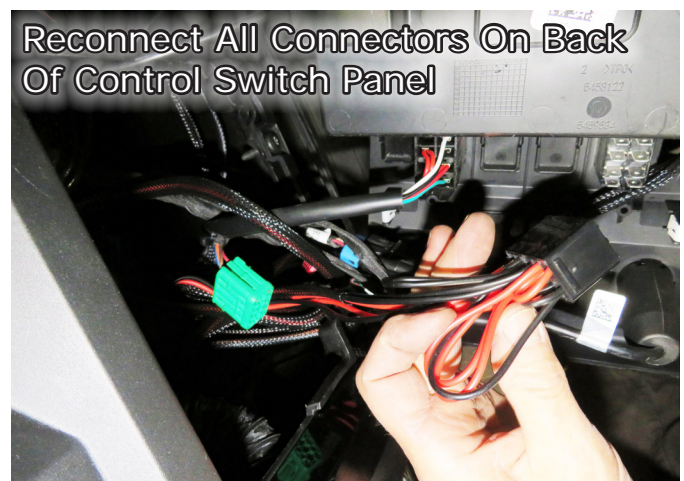

Fig.46b

47. Then reinstall the small panel back in place making sure you pull the Heater Switch Connector from the Harness out the switch slot as shown in **Fig.47a-b**.



Fig.47a

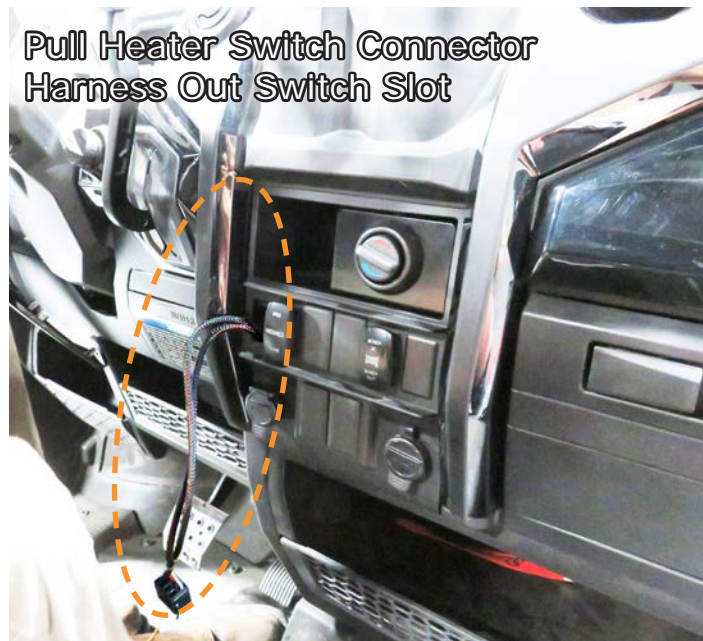

Fig.47b

48. Reinstall Side Panels as shown in **Fig.48a**. Then connect the Heater Switch to the harness connector you pulled out previously and connect the heater switch to the connector and snap the switch in to the slot secure. See **Fig.48b-c**.



Fig.48a



Fig.48b



Fig.48c

49.Reinstall all push-pins in all panels to secure. Then reinstall the Rubber Covers on top of the dash areas. See **Fig.49a-b**.



Fig.49a



Fig.49b



50.Then Reinstall the Display Cluster, Dash cover and trim. See **Fig.50a-b**.



Fig.50a



Fig.50b

51. Now looking in from the wheel well, the factory hose the farthest away from you, you will cut a 1" section out of it and insert the 3-Way "Y" Fitting in your kit. Be sure it is in the same orientation and facing the same direction as shown in **Fig.51**. Use the Band Clamps to secure the hoses to the fitting. ***This is the hose going TO the Radiator.***



Fig.51

52. The factory hose the closest you, you will cut a 1" section out of it and insert the 3-Way "Y" Fitting in your kit. Be sure it is in the same orientation and facing the same direction as shown in **Fig.52**. Use the Band Clamps to secure the hoses to the fitting. ***This is the hose with the Cold going TO the Engine.***



Fig.52

Reference Diagram For Coolant Routing

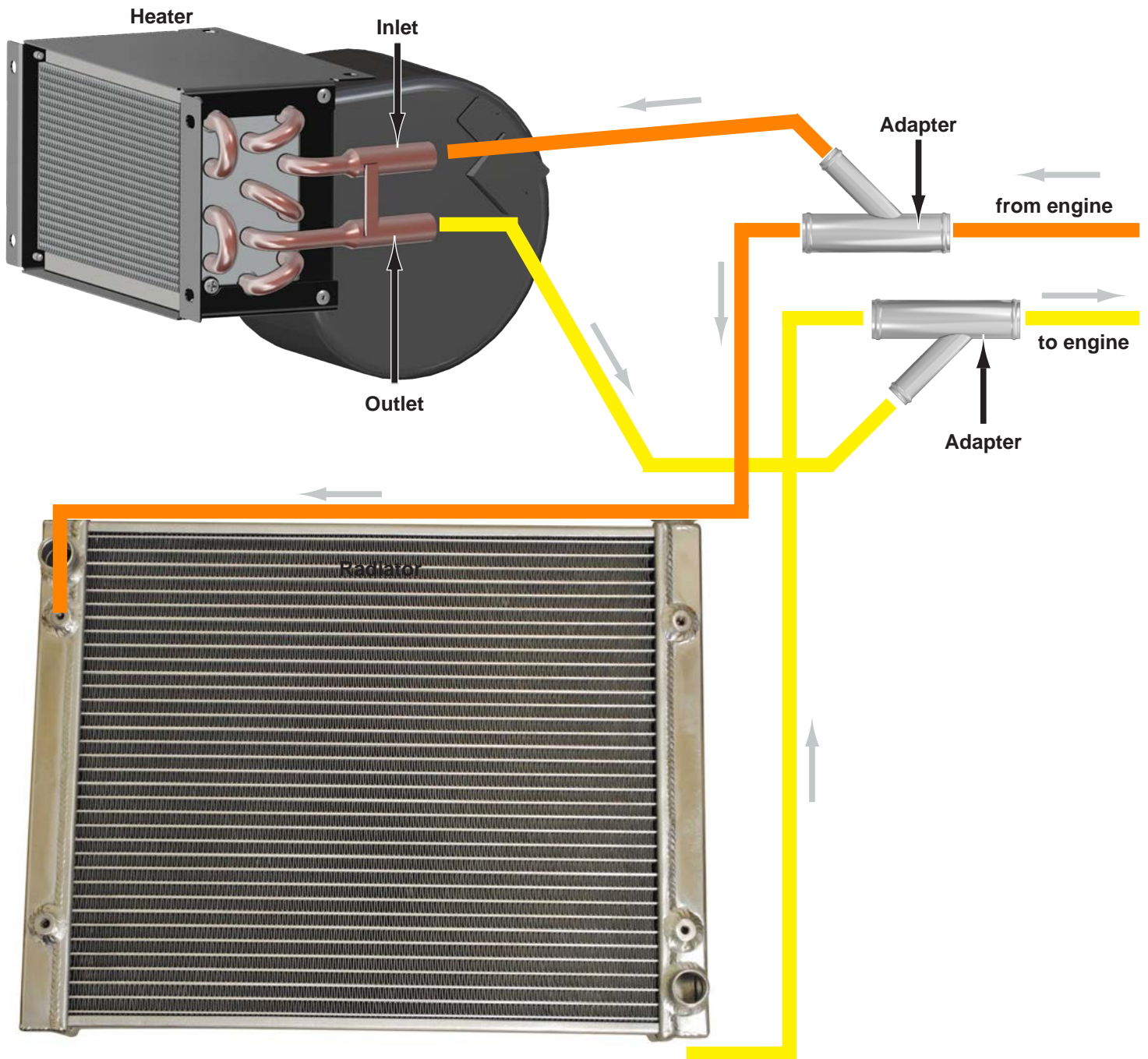



Liability Statement

SuperATV's® products are designed to best fit user's ATV/UTV under stock conditions. Adding, modifying, or fabricating any factory or aftermarket parts will void any warranty provided by SuperATV® and is not recommended. SuperATV's® products could interfere with other aftermarket accessories. If user has aftermarket products on machine, contact SuperATV® to verify that they will work together.

Although SuperATV® has thousands of satisfied customers, user should be aware that installing lift kits, long travel, or suspension kits, tires, etc. will change the ride of machine and may increase maintenance and part wear. Operating any off-road machine while, or after, consuming alcohol and/or drugs increases risk of bodily harm or death. No warranty or representation is made as to this product's ability to protect user from severe injury or death. SuperATV® urges operators and occupants to wear a helmet and appropriate riding gear at all times.

By purchasing and installing SuperATV® products, user agrees that should damages occur, SuperATV® will not be held responsible for loss of time, use, labor fees, replacement parts, or freight charges. SuperATV®, nor any 3rd party, will not be held responsible for any direct, indirect, incidental, special, or consequential damages that result from any product purchased from SuperATV®. The total liability of seller to user for all damages, losses, and causes of action, if any, shall not exceed the total purchase price paid for the product that gave rise to the claim.

SuperATV® will warranty only parts provided by SuperATV®. Any damage or problems with OEM housings, bearings, seals, or other manufacturers' products will not be covered by SuperATV®. SuperATV® parts and products are not warrantied if item was not installed properly, misused, or modified.

Installing, adding, modifying, or fabricating any factory or aftermarket product to your ATV/UTV may violate certain local, state, and federal laws. Be advised that laws vary depending on town, city, county, state, etc. Use of certain products on public streets, roads, or highways may be in violation law. The Buyer is solely and exclusively legally and personally responsible for any violation of the law by the installation or use of the product. You must abide by all local, state, and federal laws, including but not limited to vehicle safety, traffic laws, and ordinances. It is your responsibility to know the laws and how they apply to you.

The Buyer is responsible to fully understand the capability and limitations of his/her vehicle according to manufacturer specifications, warnings and instructions and agrees to hold SuperATV® harmless from any damage resulting from failure to adhere to such specifications, warnings and/ or instructions. The Buyer is also responsible to obey all applicable federal, state, and local laws and ordinances when operating his/her vehicle while using this product, and the Buyer agrees to hold SuperATV® harmless from any violation thereof.

If you have any problems/questions on this kit, contact us by email at [superatv.com](mailto:sales@superatv.com).

Need help with your installation?



sales@superatv.com



www.superatv.com



1-855-743-3427



8:00am - 9:00pm EST M-Th
8:00am - 7:00pm EST Friday
9:00am - 2:00pm EST Saturday

*Thank You
For Choosing*



Like SuperATV on Facebook to keep up to date on new products!