

Do not discard packaging until product has been successfully installed.

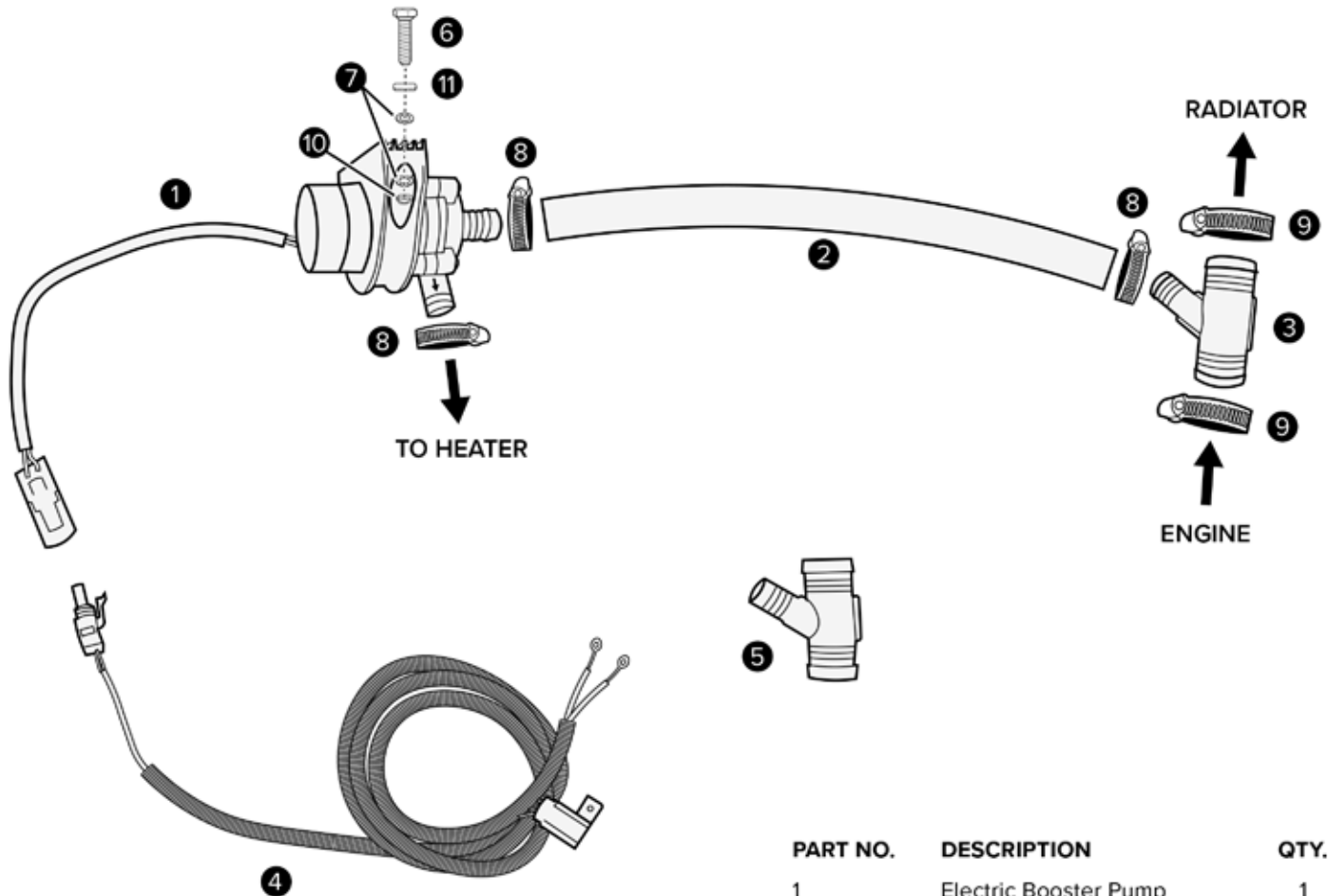

! CAUTION: Safety glasses and protective gloves should always be worn for installs. Severe damage can be caused if the air is not bled from the radiator system.

PART NO.	DESCRIPTION	QTY.
1	Electric Booster Pump	1
2	5/8" Heater Hose	1
3	Small Y-connector	1
4	Extension Wire Harness	1
5	Large Y-connector	1
6	Screw	1
7	Washer	2
8	Small Hose Clamp	3
9	Large Hose Clamp	2
10	Nut	1
11	Spacer	1

Need help with your installation?



sales@superatv.com



www.superatv.com



1-855-743-3427



8:00am - 8:00pm EST M-Th
8:00am - 7:00pm EST Friday
9:00am - 2:00pm EST Saturday

(Read instructions and view illustrations before beginning.)

*Thank You
For Choosing*



1. Before starting, allow the vehicle to cool.
NOTE: Hot coolant is under pressure and may cause serious injury
2. Disconnect the battery negative cable (black).
3. Drain engine coolant from vehicle.
4. Locate the coolant supply line to the radiator (coolant flow from engine to radiator), usually the upper radiator hose.
5. Cut 1-inch section of radiator hose from vehicle.
6. Place the two large hose clamps (9) over both ends of radiator hose and install Y-connector. See exploded view for orientation. Supplied is a large OD Y-connector (3), and a small OD Y-connector (5). This will be based on vehicle radiator hose size. Y-connector should fit snug inside of radiator hose when installed.
7. Determine mounting location of electric booster pump (1). This can be mounted in any position as long as it is protected from water splash.
8. Mount electric booster pump (1) using the provided screw (6), washers (7), spacer (11), and nut (10).
Note: Spacer is used on the screw side before the washer.
9. Run the 5/8" heater hose (2) from the installed Y-connector (3 or 5), to the electric booster pump (1). Cut hose to allow for installation.
10. Place small hose clamps (8) over the cut 5/8" heater hose (2), and install on vehicle.
11. Connect electric booster pump to heater using a small hose clamp (8). See exploded view for reference.
12. Tighten all hose clamps (8, 9).
13. Connect extension wire harness (4) to the electric boost pump (1) connector, and route to the heater. Connect harness to heater power when heater fan is turned on (red wire to heater, black wire to vehicle ground). Alternatively, harness may be wired to vehicle keyed accessory bus bar or accessory port. An on/off switch for the harness would be recommended.
14. Fill cooling system with manufacturer's recommended engine coolant, and then bleed system.
15. Connect battery negative cable.
16. Turn on key and start vehicle. Let vehicle warm up to operating temperature to verify proper bleeding of engine cooling system. If connected to "heater on" circuit, the electric booster pump will operate when the heater is turned on. If using alternative method, the electric booster pump will be turned on or off using a switch or keyed power.

CUSTOMER NOTIFICATION AND DISCLAIMER LIABILITY

This product is a modification for utility task vehicles and all terrain vehicles. Use this product at your own risk.

Warranty and Liability Limitations. The Buyer hereby assumes all risks associated with the use and/or installation of this product. Buyer waives all liability claims against SuperATV® of any kind or nature, including, but not limited to, liability for penalties, fines, property damage, personal injury or death, to the fullest extent permitted by law. Buyer acknowledges and agrees that SuperATV® is not liable for any direct, indirect, incidental, consequential or special damages, including but not limited to, damage, loss of life, loss of property or equipment, loss of profits or revenue, injury, or claims from any individual or entity arising from the use of this product.

The warranty for this product, if any, may give you ("Buyer") specific legal rights, and Buyer may also have other rights which may vary from state to state. The installation of this product may void or otherwise adversely affect your factory warranty.

Consult your vehicle warranty before using this Product. Under no circumstances will SuperATV® be liable for the voidance of the Buyer's vehicle warranty. Buyer assumes all risk and responsibility if a manufacturer and/or dealer voids the Buyer's vehicle warranty due to use of this Product.

Safety and Laws. Operate your vehicle at all times in a safe manner. You must abide by all local, state, and federal laws, including but not limited to vehicle safety, traffic laws, and ordinances. It is your responsibility to know the laws and how they apply to you. The installation of this product may violate certain local, state, and federal laws. Be advised that laws vary depending on town, city, county, state, etc. Use of this product on public streets, roads, or highways may be in violation law. The Buyer is solely and exclusively legally and personally responsible for any violation of the law by the installation or use of this product. In no case will SuperATV® be held liable if Buyer violates the law or uses the product in an unsafe manner.

The Buyer is responsible to fully understand the capability and limitations of his/her vehicle according to manufacturer specifications, warnings and instructions and agrees to hold SuperATV® harmless from any damage resulting from failure to adhere to such specifications, warnings and/ or instructions. The Buyer is also responsible to obey all applicable federal, state, and local laws when operating his/her vehicle while using this product, and the Buyer agrees to hold SuperATV® harmless from any violation thereof.

Installation. The installation of this product on your vehicle indicates that you have had the opportunity to inquire about applicable local, state, and federal laws and ordinances and that you have read and understand, and accept all of the terms of, this Disclaimer.

SuperATV® shall not be responsible for the proper installation, use, and service of this product. Rather, the Buyer shall be solely responsible for the installation of the product and any damage that may be done to the vehicle or vehicle components as a result of modifications made by the Buyer.