

INSTALLATION INSTRUCTIONS

Long Travel Kit: for Polaris General[®]

Item	Description	Item	Description
A	Front Upper - R	E	Rear Upper - R
B	Front Upper - L	F	Rear Upper - L
C	Front Lower - R	G	Rear Lower - R
D	Front Lower - L	H	Rear Lower - L

- Do not discard packaging until product has been successfully installed.
- A Press or Ball Joint tool is required to remove and install Ball Joints.
- Driver side installation shown in illustrations.

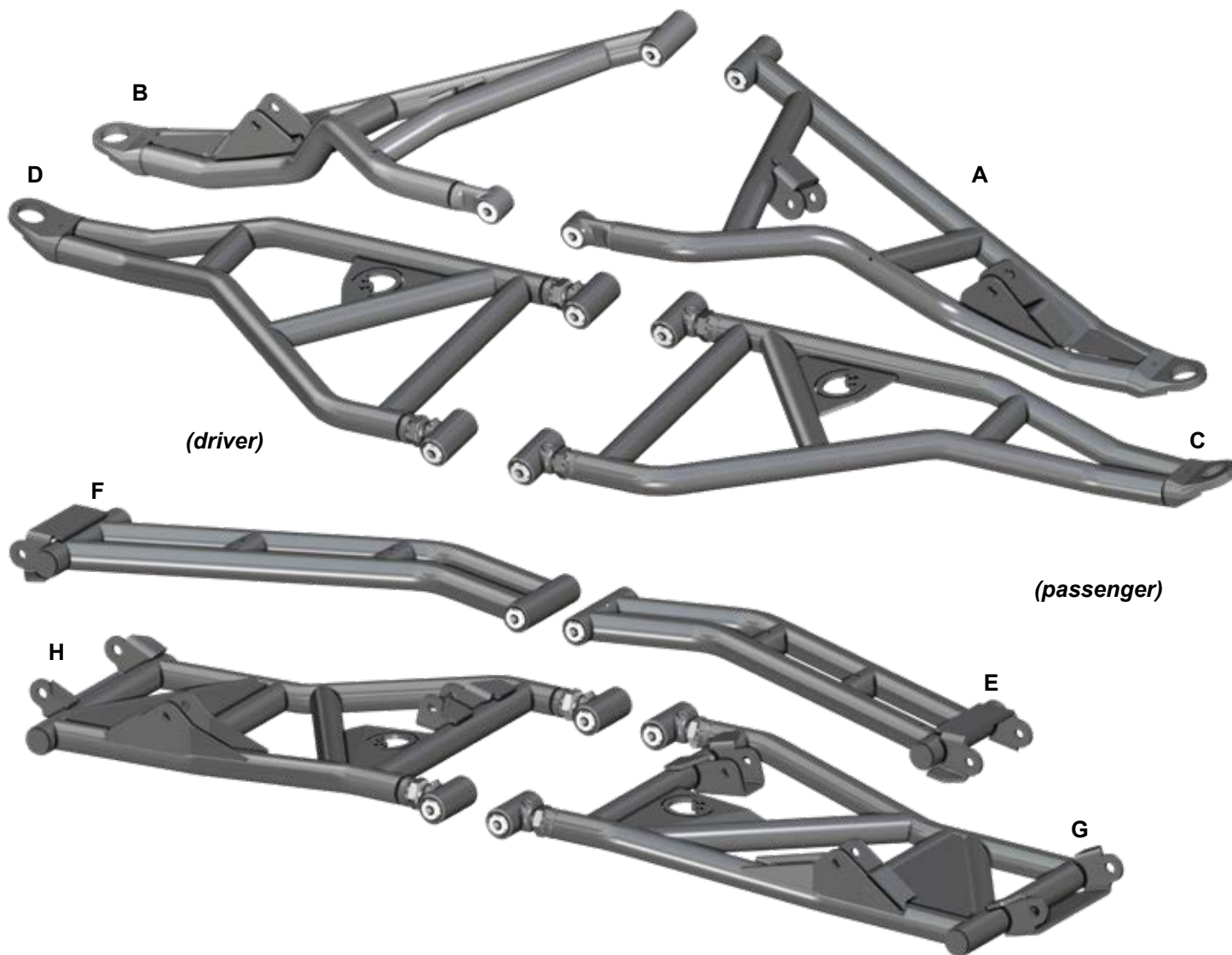

(kit contents continue on following pages)

Need help with your installation?



sales@superatv.com



www.superatv.com



1-855-743-3427



8:00am - 8:00pm EST M-Th
8:00am - 7:00pm EST Friday
9:00am - 2:00pm EST Saturday

Read instructions and view illustrations before beginning.

Thank You
For Choosing

SUPERATV.COM[®]

(kit contents continued)

Item	Description
J	Front Bracket
K	Rear Brace
L	Shock Bracket - R
M	Shock Bracket - L

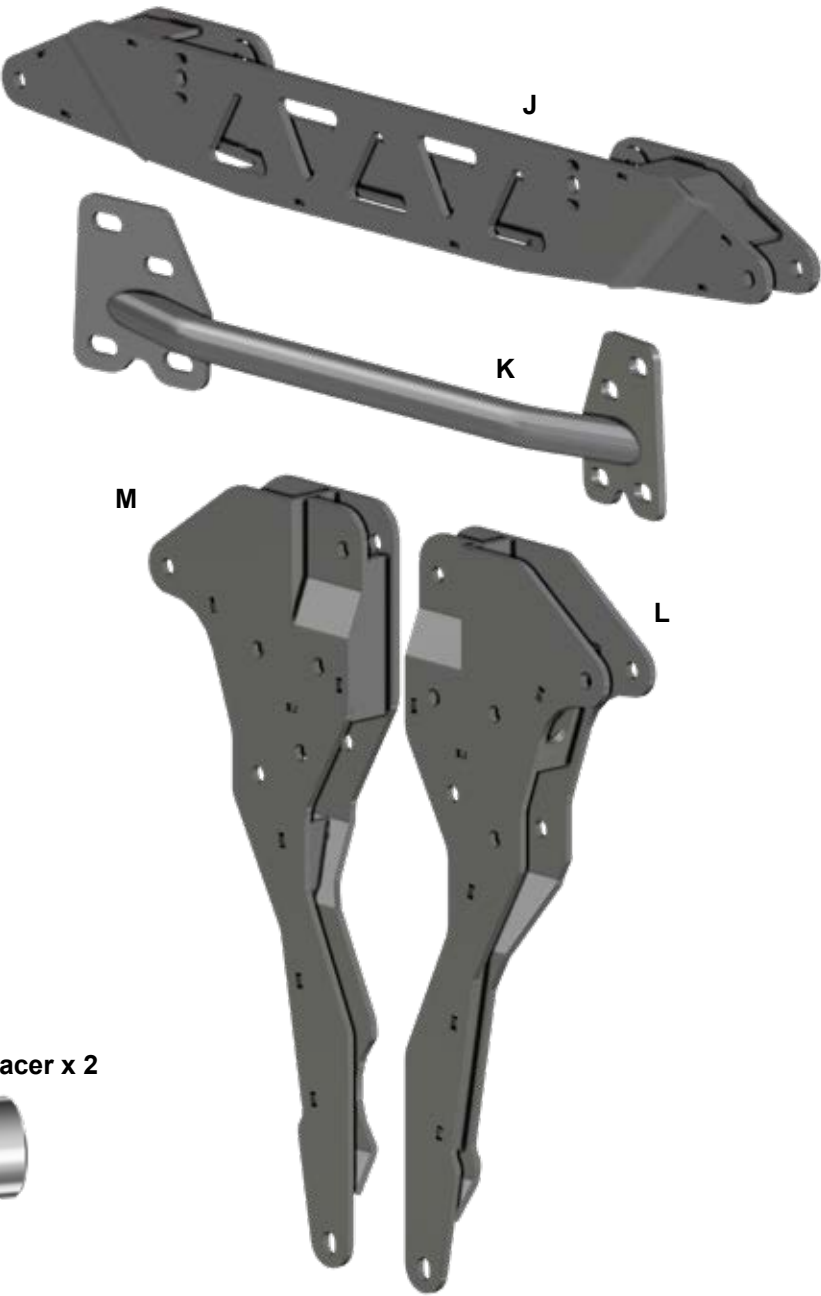

Pivot Bushing Spacer x 2



Front Right
(56")



Front Left
(42")



Rear Right
(60")



Rear Left
(48")

Front Brake Lines have same style fittings at each end.

(kit contents continued)

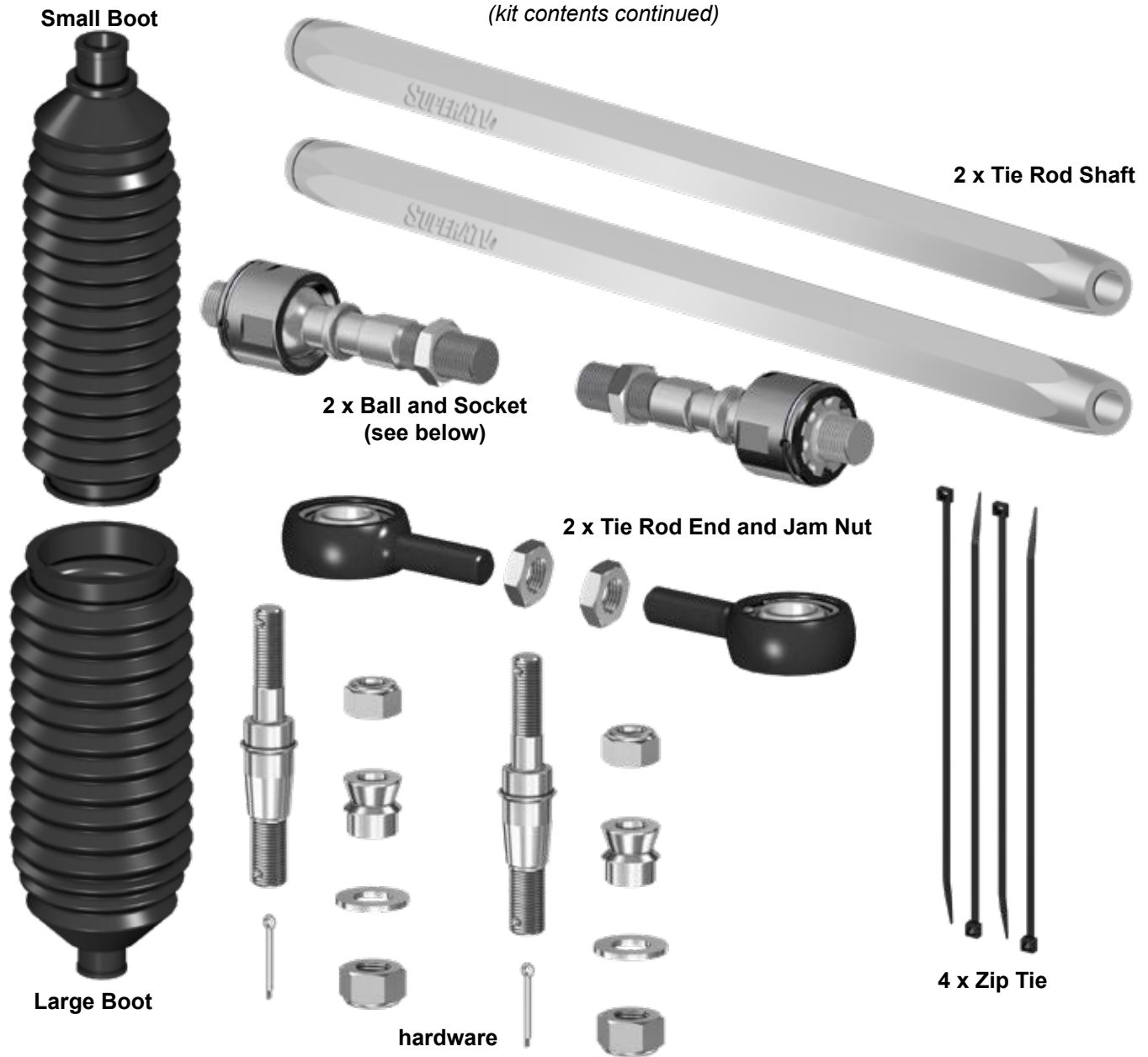

- Inner Tie Rod End is adjustable and can be tightened.
- Remove Clip and loosen (4) Set Screws
- Screw Inner Tie Rod End into Cup.

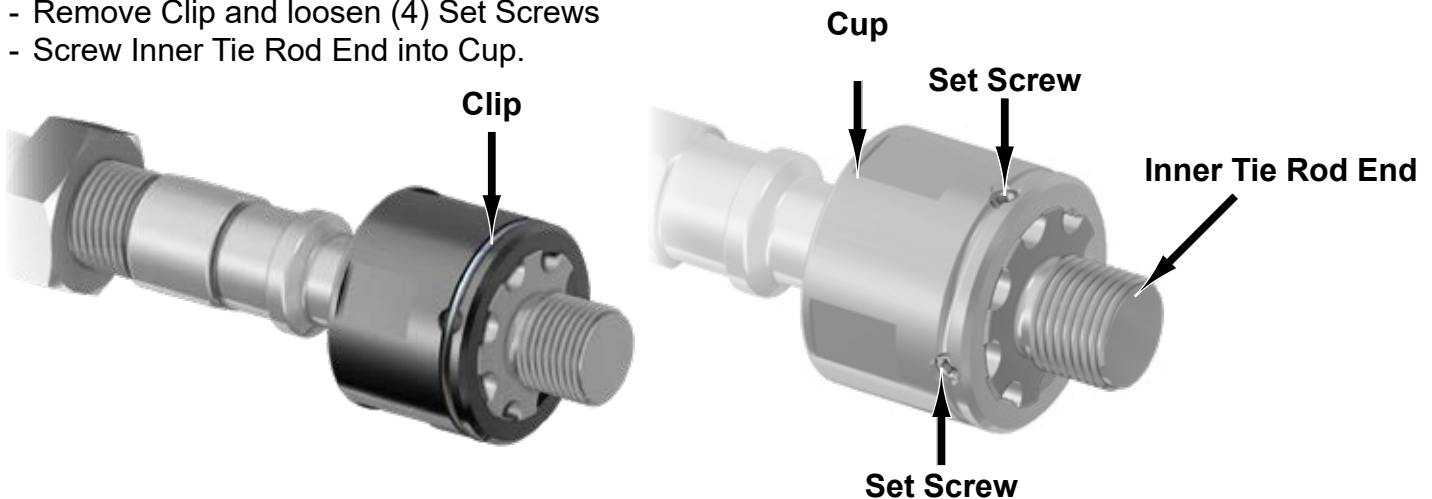

Front Components Removal: Keep all components removed from machine.



Rear Components Removal: Keep all components removed from machine.

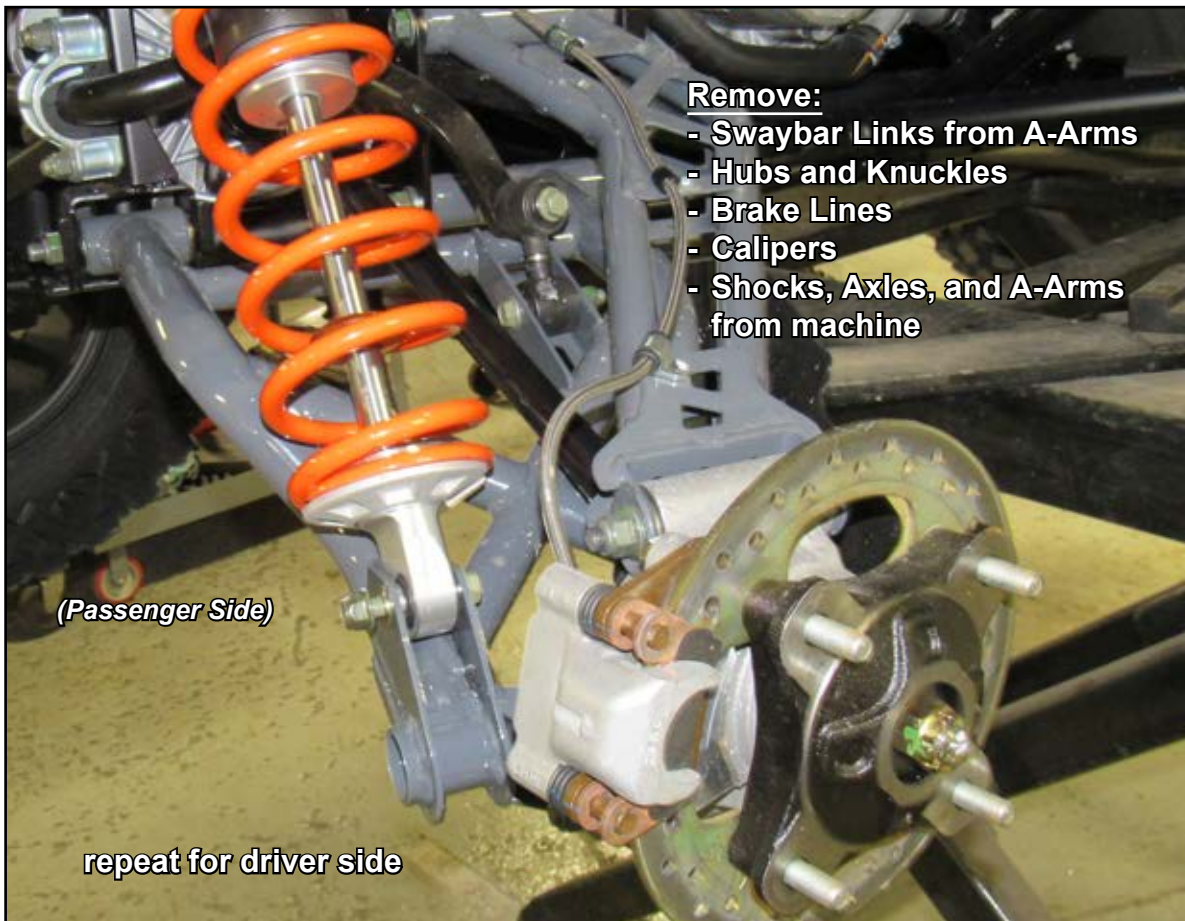

Front A-Arms Prep:

- Install Fittings shown.

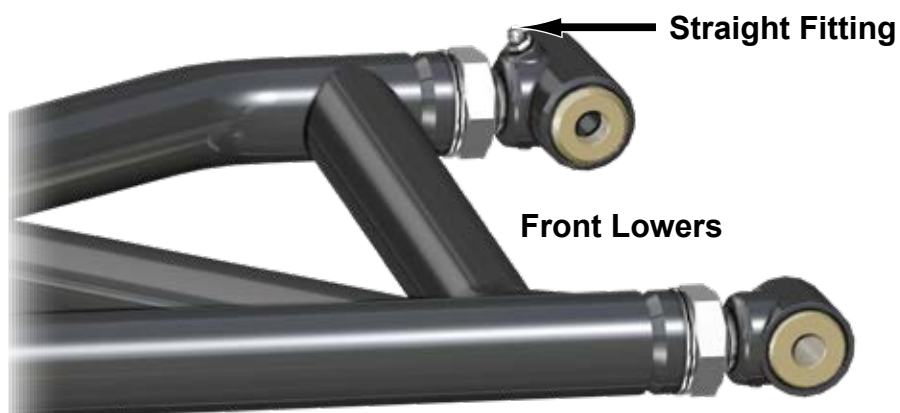
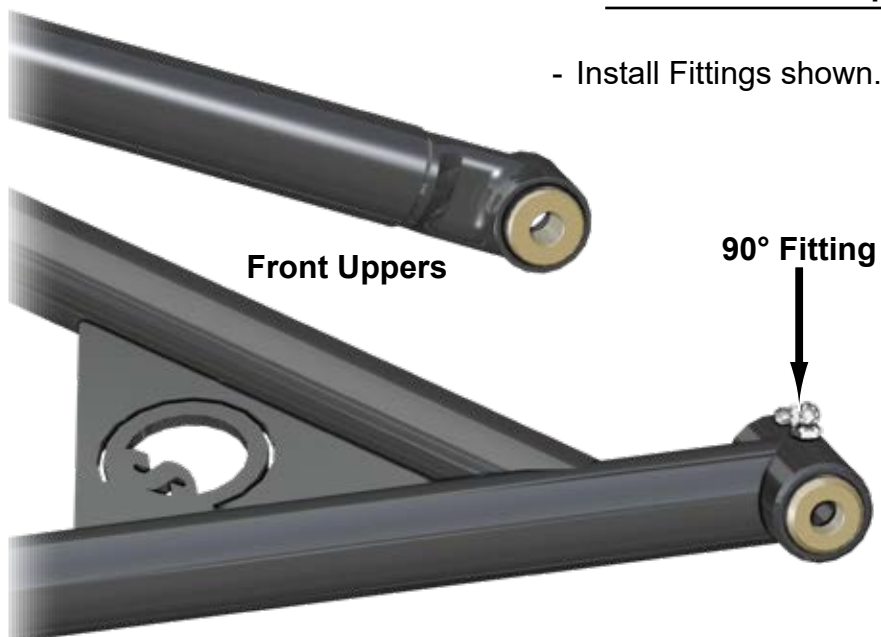

Install SuperATV or stock Ball Joints



Rear A-Arms Prep:

- Install Fittings shown.

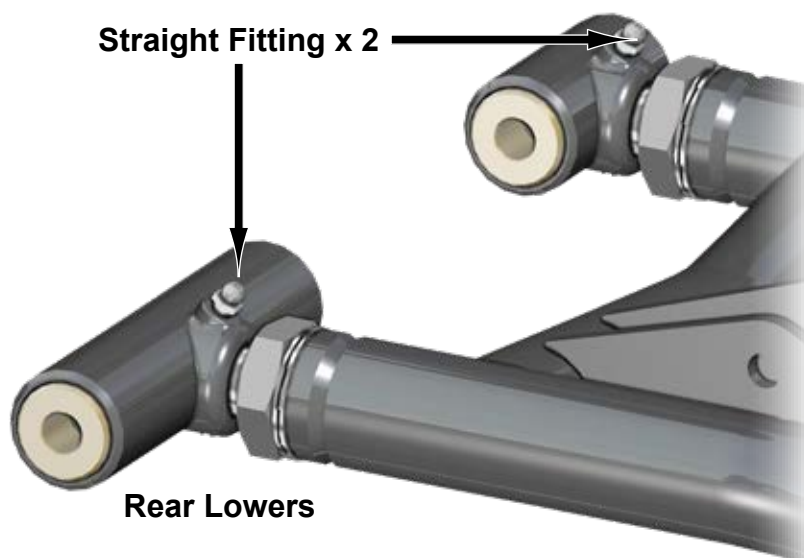
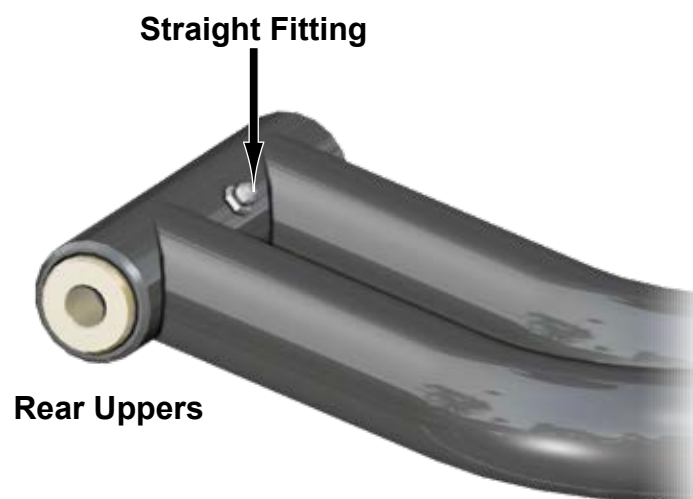

PIVOT BLOCK SETTINGS

- Place new A-Arms onto a flat surface and verify dimension shown.
- *Negative 1° camber setting is achieved when Pivot Blocks are set to this dimension.*
- See last page for additional camber information.

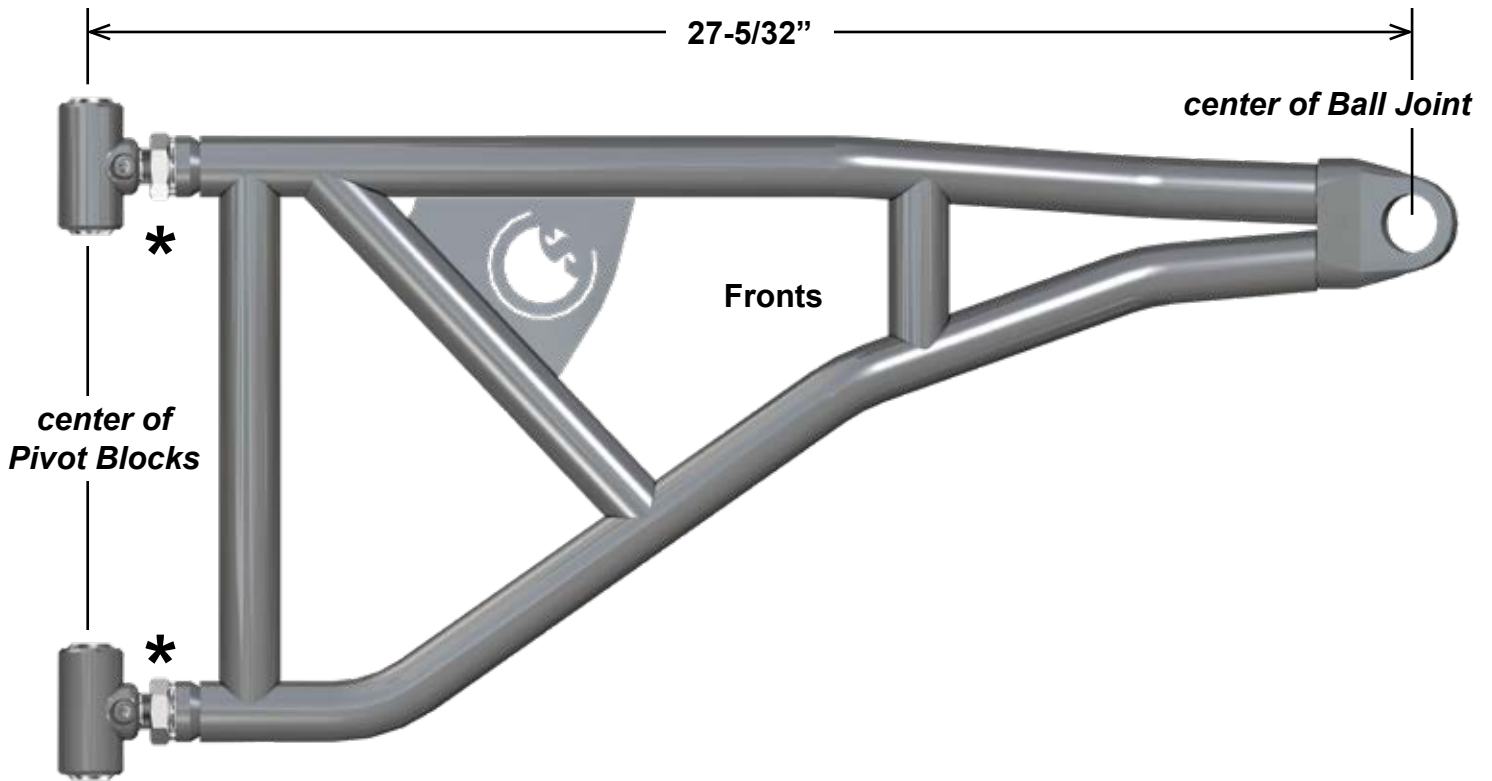

*Leave Jam Nuts loose. Tighten after final adjustments have been made.

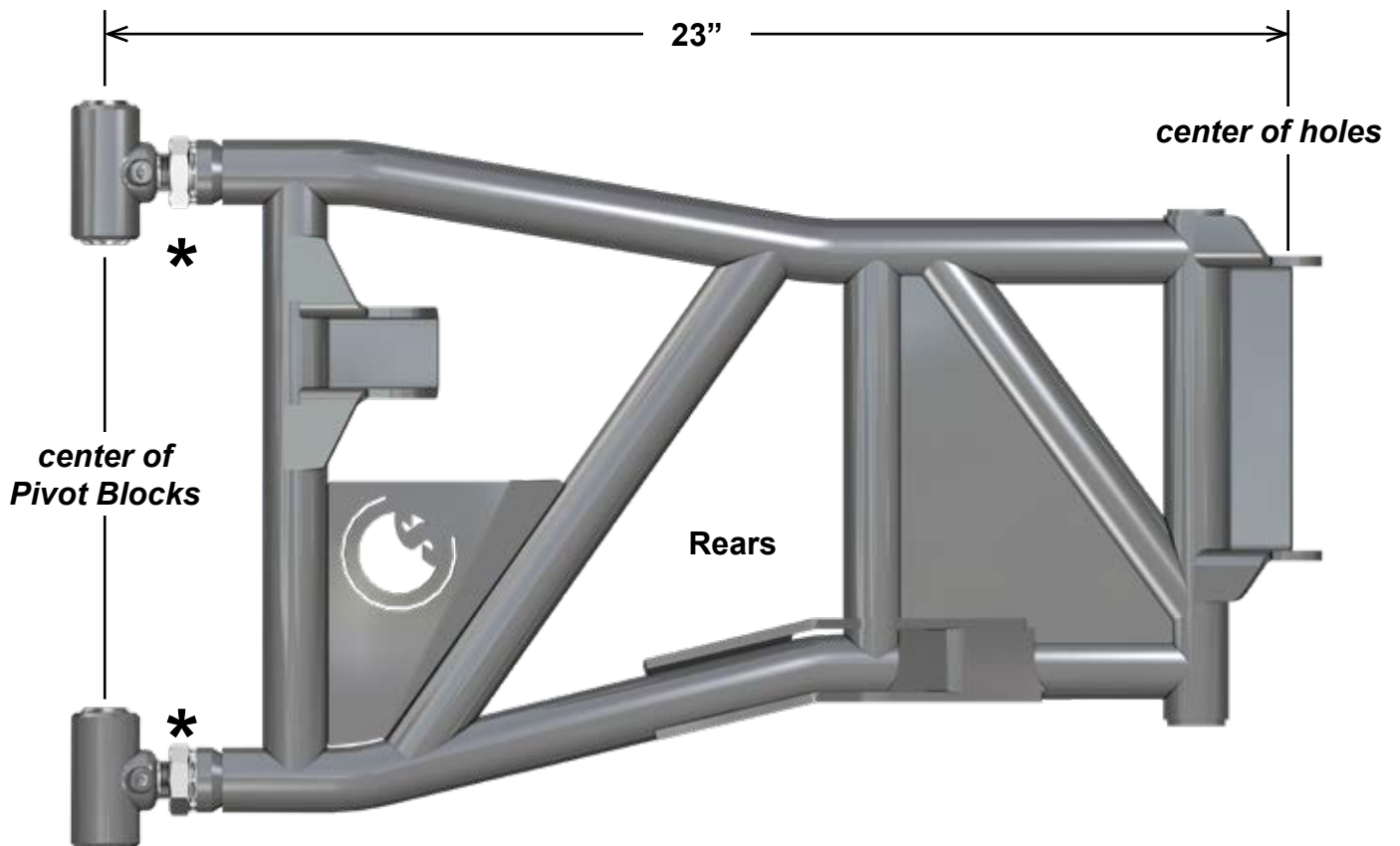

- Install Front Bracket (J) to Frame with hardware shown; do not tighten.

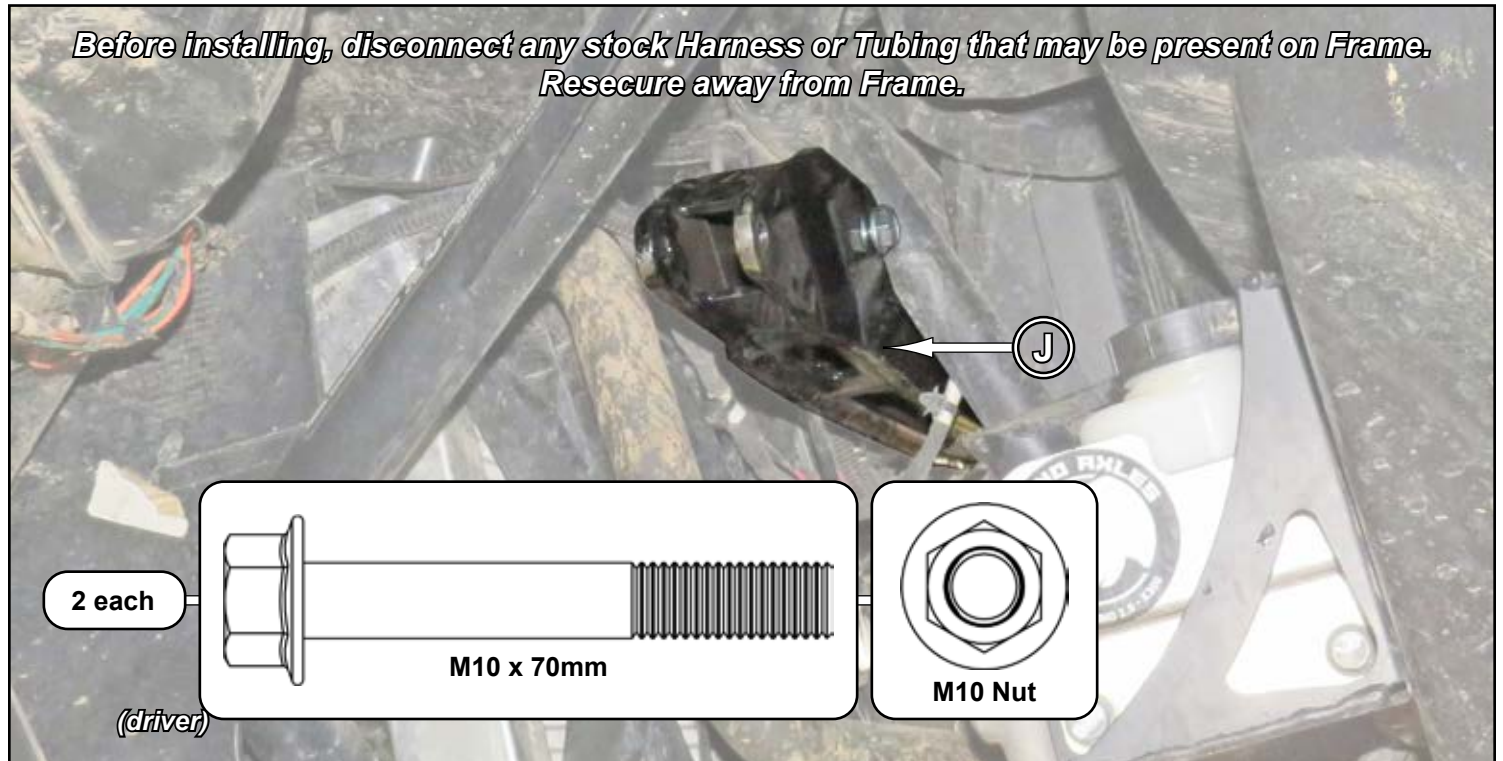

- Remove Jam Nuts from Ball and Sockets.
- Install Ball and Sockets to Rack and Pinion. Use Loctite.
- Install Boots to Rack and Pinion and secure with Wire Ties.
- Reinstall Jam Nuts to Ball and Sockets.
- Install Tie Rod Shafts to Ball and Sockets.

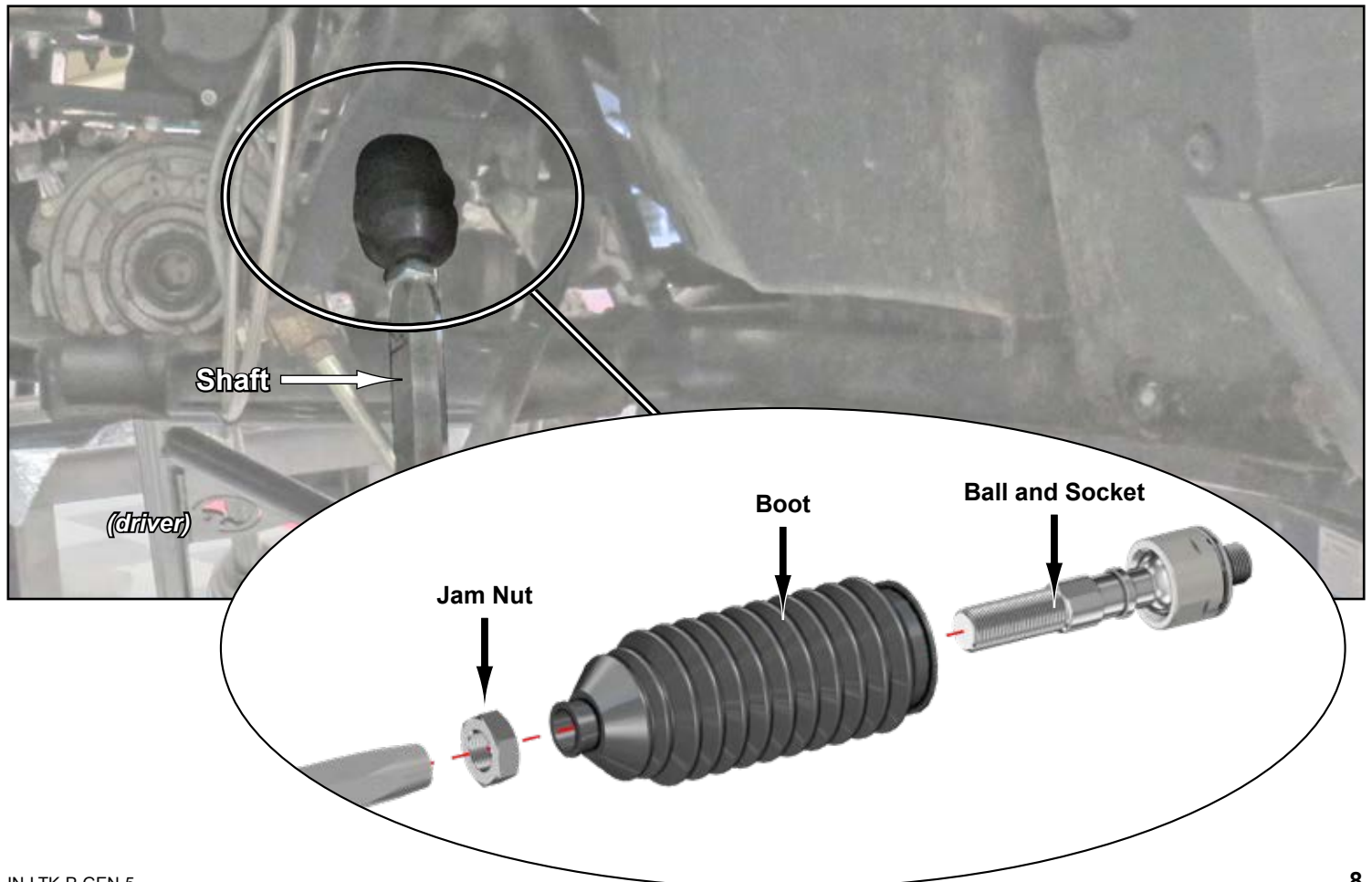

- Install Front Lower - L (D) to Frame with stock hardware; **keep Nuts loose until all final adjustments have been completed.**



- Install new Front Axle.



- Install Front Upper - L (B) to Frame with stock hardware. Tighten hardware. SuperATV recommends using Loc-Tite on Nuts.



- Secure Sway Bar Link to Front Upper - L (B) with stock hardware; tighten.

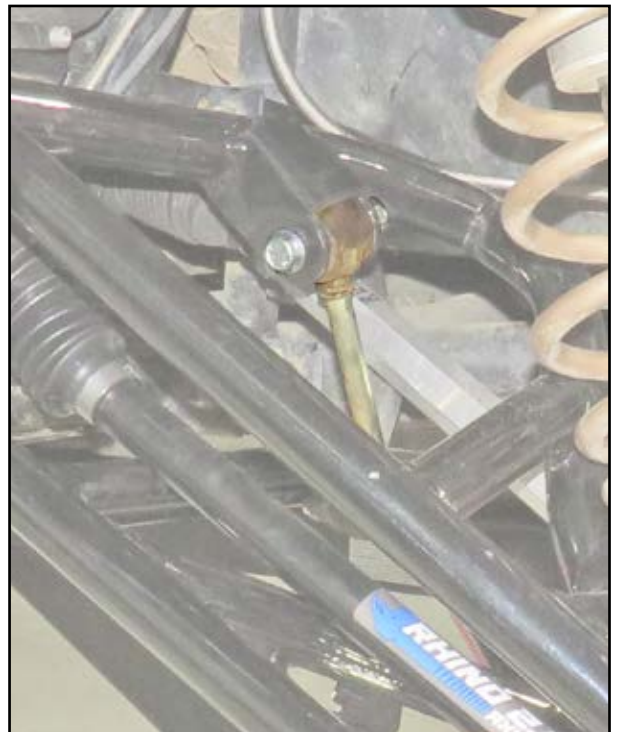

- Install Knuckle to Arms with stock hardware; **keep Lower Nuts loose until all final adjustments have been completed.**
- Secure Tie Rod End to Knuckle with hardware shown.



- Repeat for passenger side A-Arm installation.

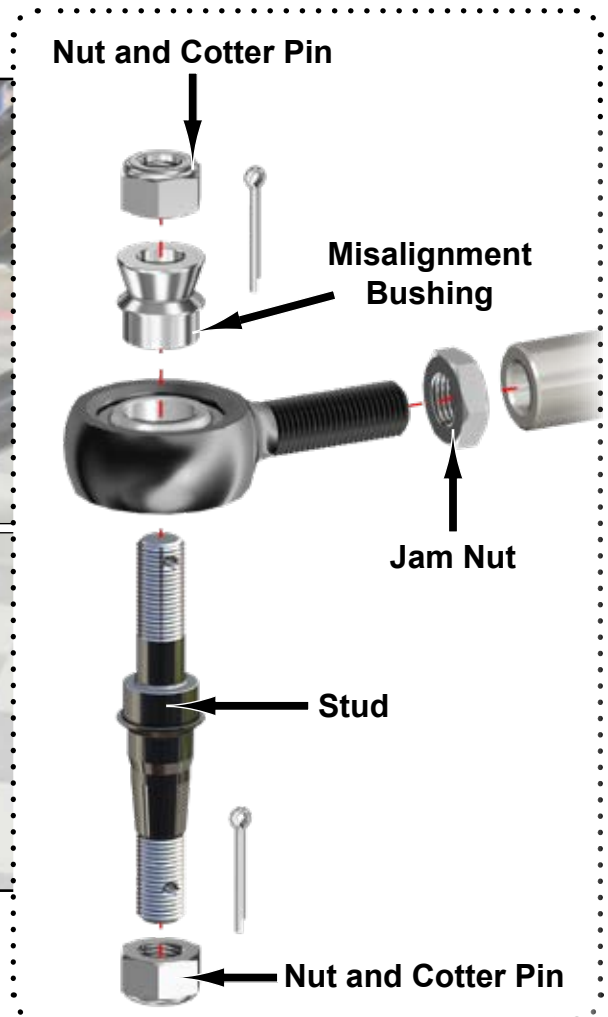

- Reinstall Hubs and Calipers.
- Install provided Brake Lines to Calipers and Master Cylinder.
- Secure Brake Lines to Upper A-Arms with components shown; tighten.
- Ensure that no binding occurs after Brake Line has been installed and secured.



- Secure Shock to Upper Arms and Front Bracket (J) with hardware shown; tighten.

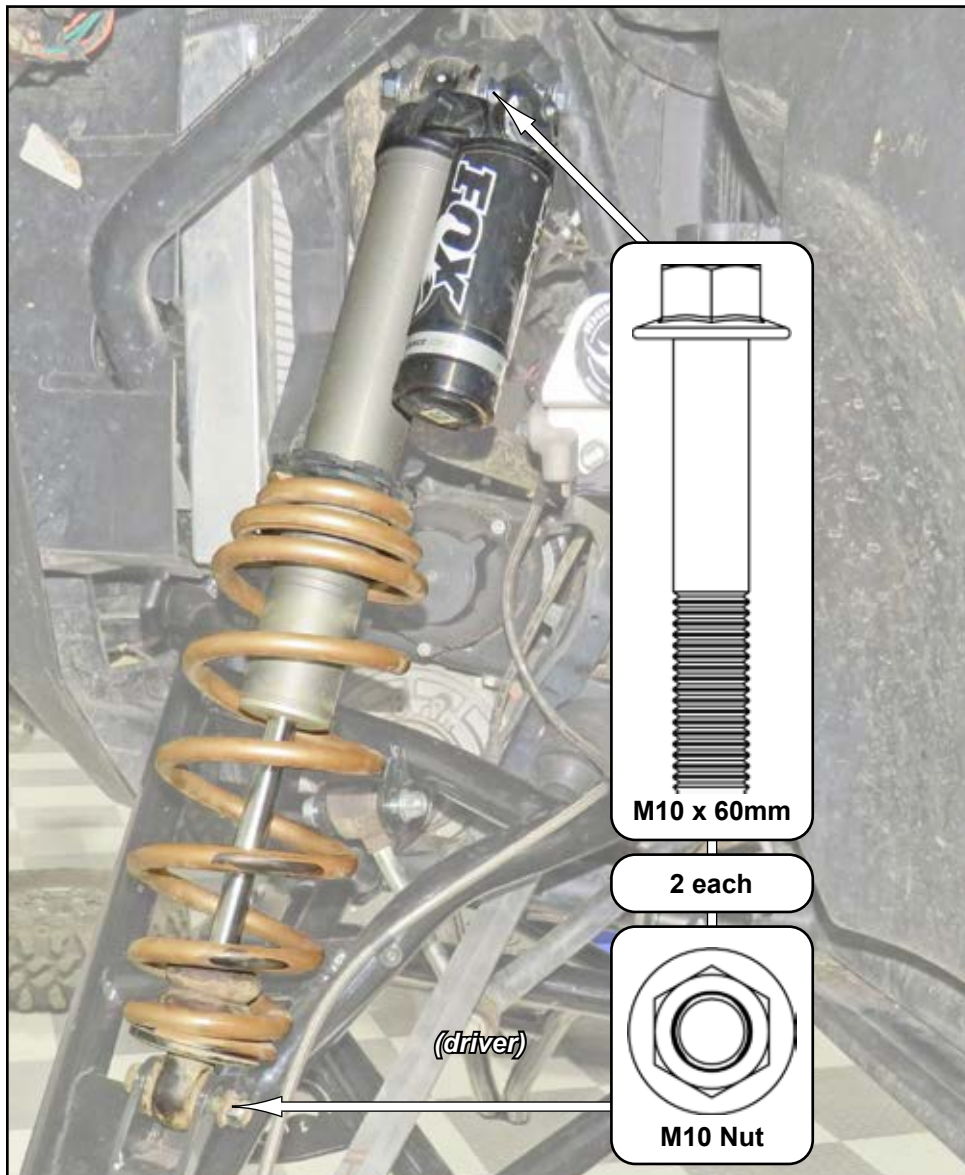

- Place Rear Brace (K) into and through Frame as shown.



- Install Rear Lower - L (H) to Frame with hardware shown; **keep Nut loose until all final adjustments have been completed.**



- Place lower portion of Shock Bracket - L (M) onto previously installed M10 x 100mm bolt. Secure with M10 Nut; **keep Nut loose until all final adjustments have been completed.**
- Secure Shock Bracket - L (M) to stock Shock Mount with stock Shock hardware; tighten.
- Secure Shock Bracket - L (M) to Rear Brace (K) with hardware shown; do not tighten.

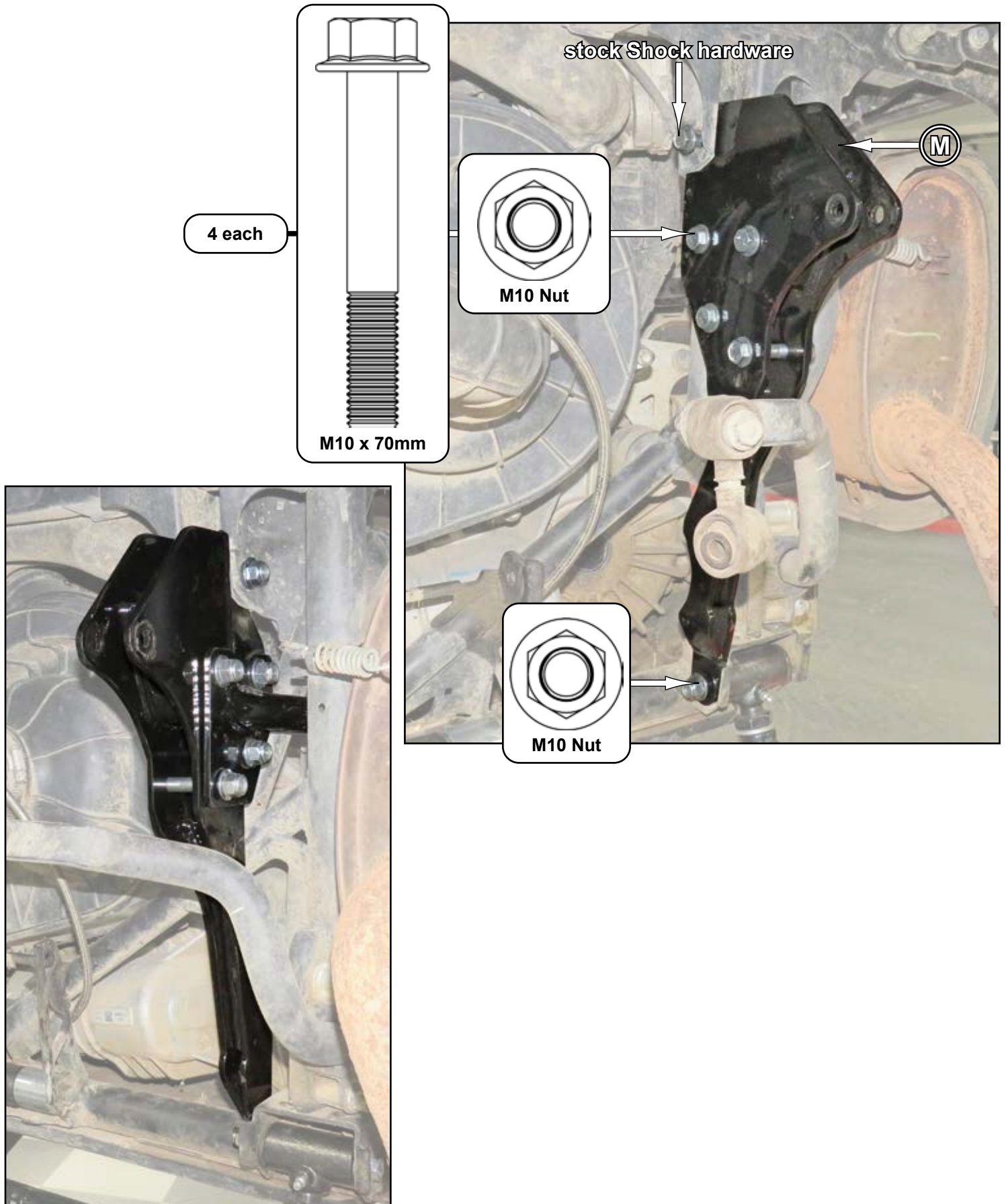

- Install new Rear Axle.
- Install Rear Upper - L (F) to Frame with stock hardware; tighten. SuperATV recommends using Loc-Tite on Nuts.



- Install Knuckle to Arms with stock hardware; ***keep Lower Nuts loose until all final adjustments have been completed.***



- Secure Shock to Rear Upper - L (F) and Shock Bracket - L (M) with hardware shown; tighten.
- Secure Sway Bar Link to Rear Upper - L (F) with stock hardware; tighten.

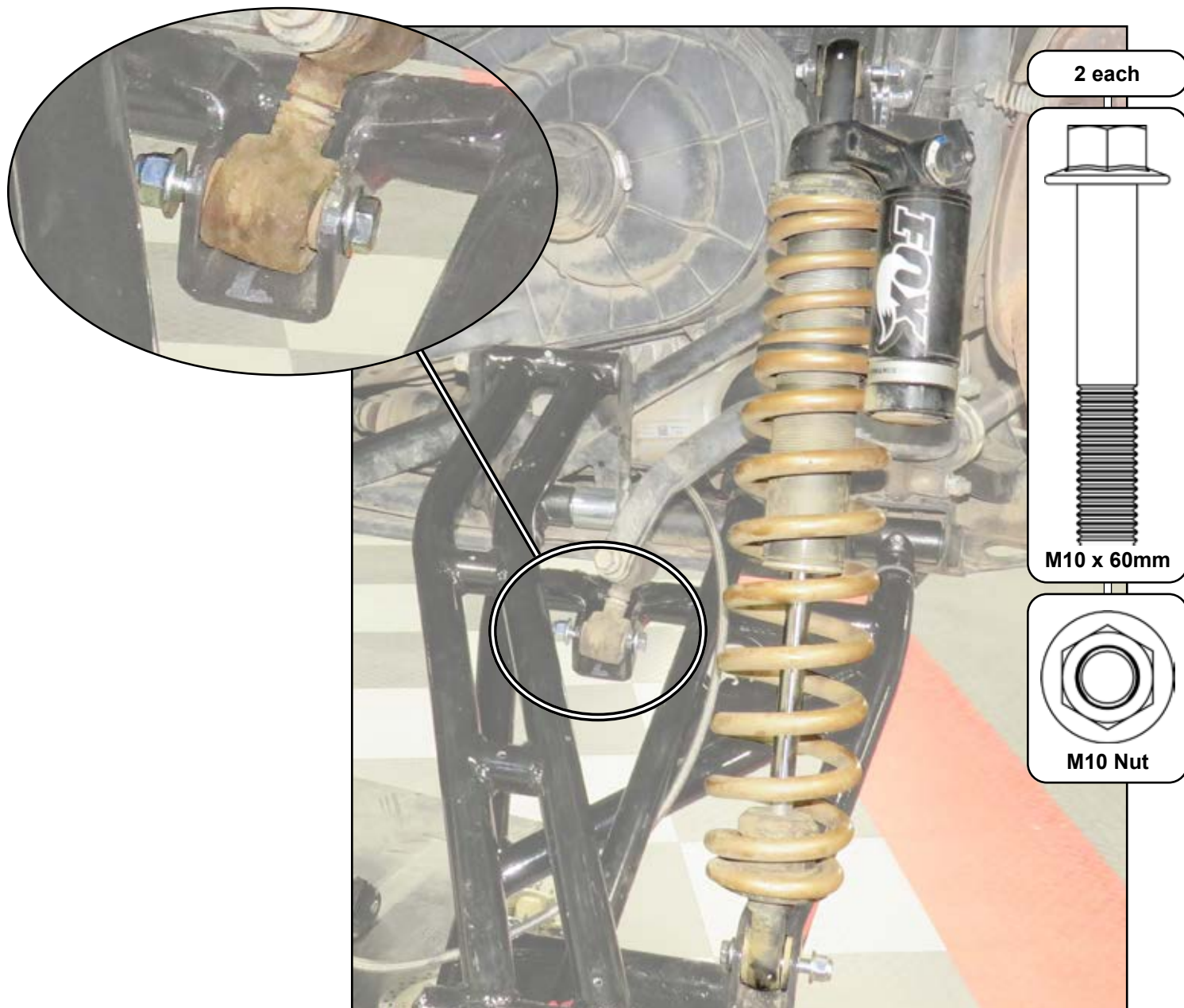

- Repeat for passenger side A-Arm installation.

- Reinstall Hubs and Calipers.
- Install provided Brake Lines.
- Secure Brake Lines to Upper A-Arms with components shown; tighten.
- Ensure that no binding occurs after Brake Line has been installed and secured.

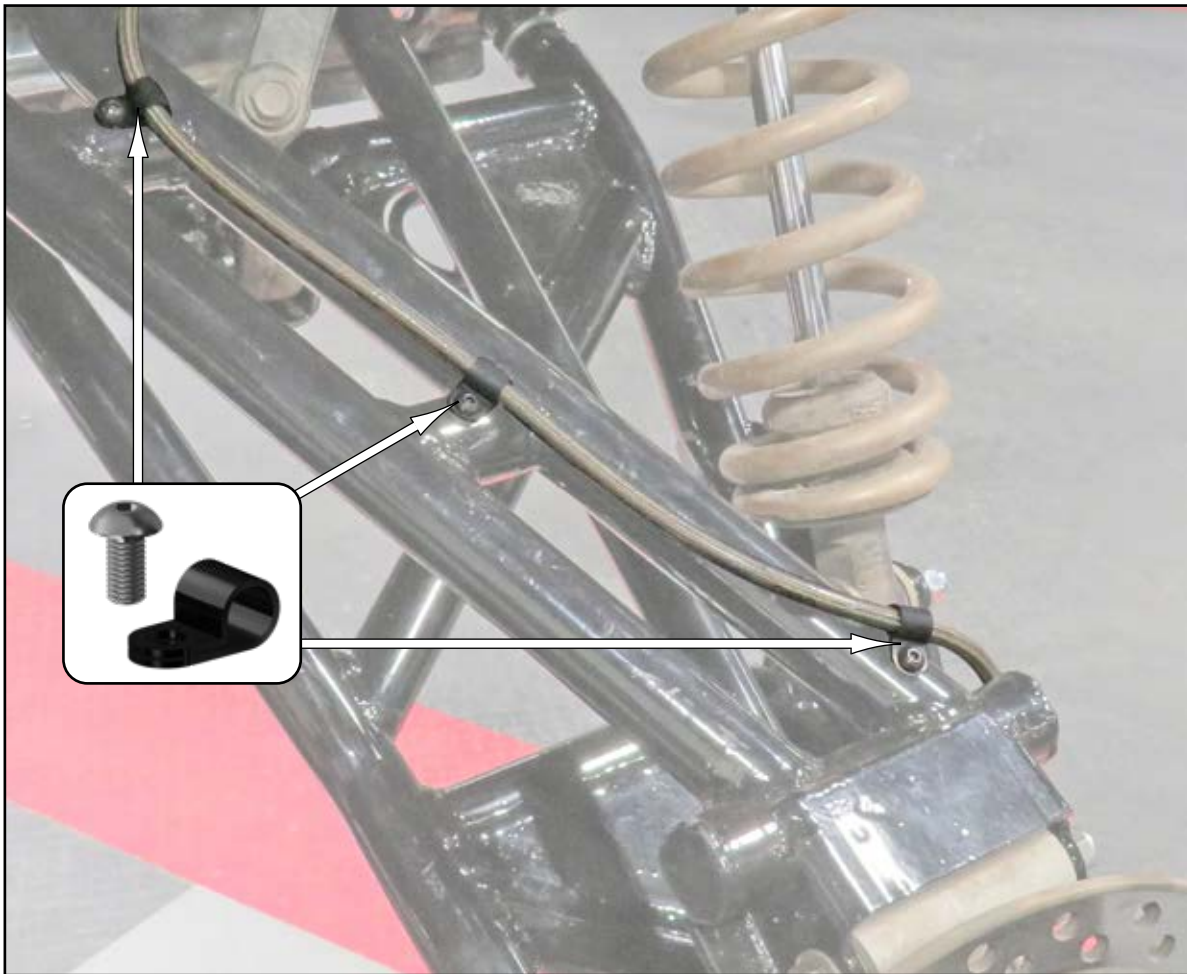

- Reinstall Tires and check Camber settings; see following page.
- Tighten all loose Nuts completely. SuperATV recommends using Loc-Tite on Nuts.

- Set toe of vehicle.
- Loosen Jam Nuts and apply Bonding Agent to Tie Rod End threads and Ball and Socket threads.

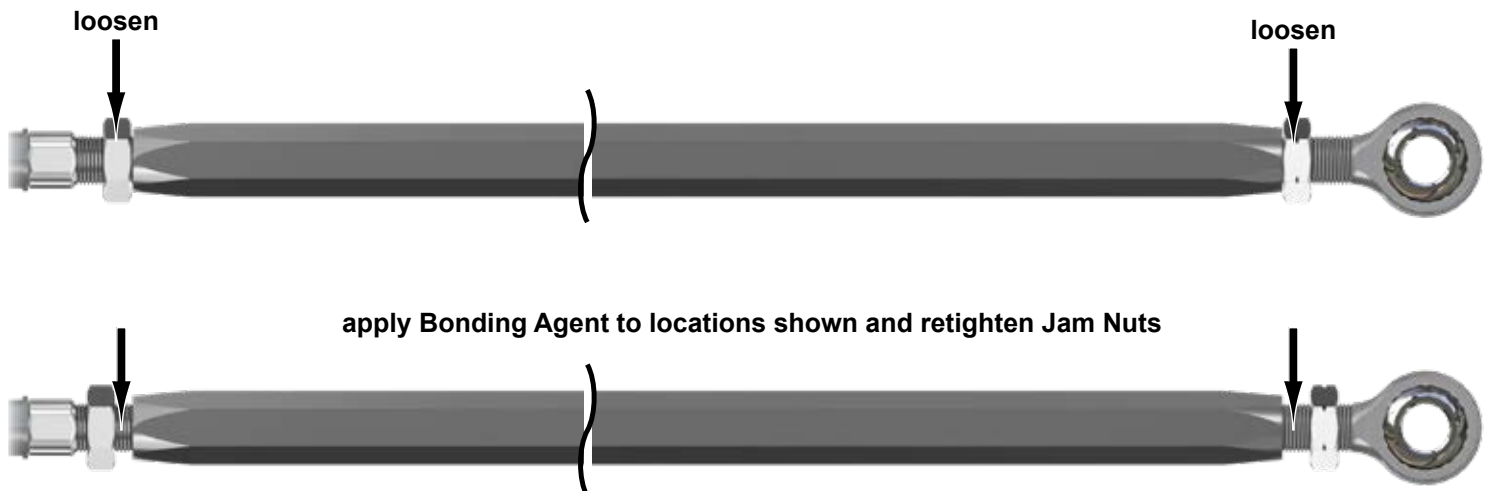

CAMBER

- Tires must have equal air pressure before making adjustments.
- Adjustments to be made after all suspension components have been completely assembled.
- Tires must not be in contact with ground when making adjustments.
- Perform adjustments in small increments.



Adjusting Camber:

- Remove A-Arms from Frame and turn Pivot Blocks to adjust camber. Reinstall Arms.
- Lower machine and settle suspension components by rolling machine back and forth several feet at a time.
- Check settings and make small adjustments as needed.
- Each time an adjustment is made, machine must be rolled back and forth to settle suspension components.
- Once desired setting is achieved, tighten hardware completely. Loc-tite on Nuts is recommended.

A NEGATIVE CAMBER SETTING OF 1° to 2° IS RECOMMENDED.

LOWER:

Too much positive camber: adjust Pivot Blocks **OUT**.

Too much negative camber: adjust Pivot Blocks **IN**.

note: 2 full turns is 1°

UPPER A-ARMS:

Too much positive camber: adjust Pivot Blocks **IN**.

Too much negative camber: adjust Pivot Blocks **OUT**.

note: 2 full turns is 1°

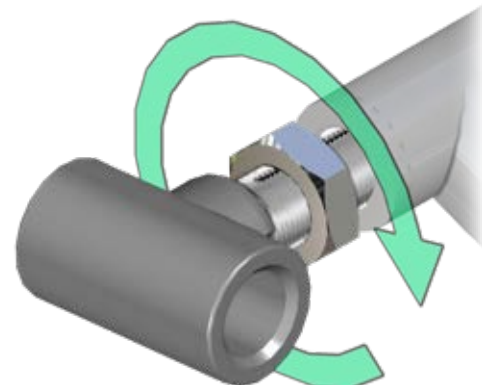

Liability Statement

SuperATV's® products are designed to best fit user's ATV/UTV under stock conditions. Adding, modifying, or fabricating any factory or aftermarket parts will void any warranty provided by SuperATV® and is not recommended. SuperATV's® products could interfere with other aftermarket accessories. If user has aftermarket products on machine, contact SuperATV® to verify that they will work together.

Although SuperATV® has thousands of satisfied customers, user should be aware that installing lift kits, long travel, or suspension kits, tires, etc. will change the ride of machine and may increase maintenance and part wear. Operating any off-road machine while, or after, consuming alcohol and/or drugs increases risk of bodily harm or death. No warranty or representation is made as to this product's ability to protect user from severe injury or death. SuperATV® urges operators and occupants to wear a helmet and appropriate riding gear at all times.

By purchasing and installing SuperATV® products, user agrees that should damages occur, SuperATV® will not be held responsible for loss of time, use, labor fees, replacement parts, or freight charges. SuperATV®, nor any 3rd party, will not be held responsible for any direct, indirect, incidental, special, or consequential damages that result from any product purchased from SuperATV®. The total liability of seller to user for all damages, losses, and causes of action, if any, shall not exceed the total purchase price paid for the product that gave rise to the claim.

SuperATV® will warranty only parts provided by SuperATV®. Any damage or problems with OEM housings, bearings, seals, or other manufacturers' products will not be covered by SuperATV®. SuperATV® parts and products are not warranted if item was not installed properly, misused, or modified.

Installing, adding, modifying, or fabricating any factory or aftermarket product to your ATV/UTV may violate certain local, state, and federal laws. Be advised that laws vary depending on town, city, county, state, etc. Use of certain products on public streets, roads, or highways may be in violation law. The Buyer is solely and exclusively legally and personally responsible for any violation of the law by the installation or use of the product. You must abide by all local, state, and federal laws, including but not limited to vehicle safety, traffic laws, and ordinances. It is your responsibility to know the laws and how they apply to you.

The Buyer is responsible to fully understand the capability and limitations of his/her vehicle according to manufacturer specifications, warnings and instructions and agrees to hold SuperATV® harmless from any damage resulting from failure to adhere to such specifications, warnings and/ or instructions. The Buyer is also responsible to obey all applicable federal, state, and local laws and ordinances when operating his/her vehicle while using this product, and the Buyer agrees to hold SuperATV® harmless from any violation thereof.