

- Do not discard packaging until product has been successfully installed.
- A Press or Ball Joint tool is required to remove and install Ball Joints.
- Disregard any remaining hardware.

Item	Description	Item	Description
A	Upper - L	E	Upper - L
B	Upper - R	F	Upper - R
C	Lower - L	G	Lower - L
D	Lower - R	H	Lower - R

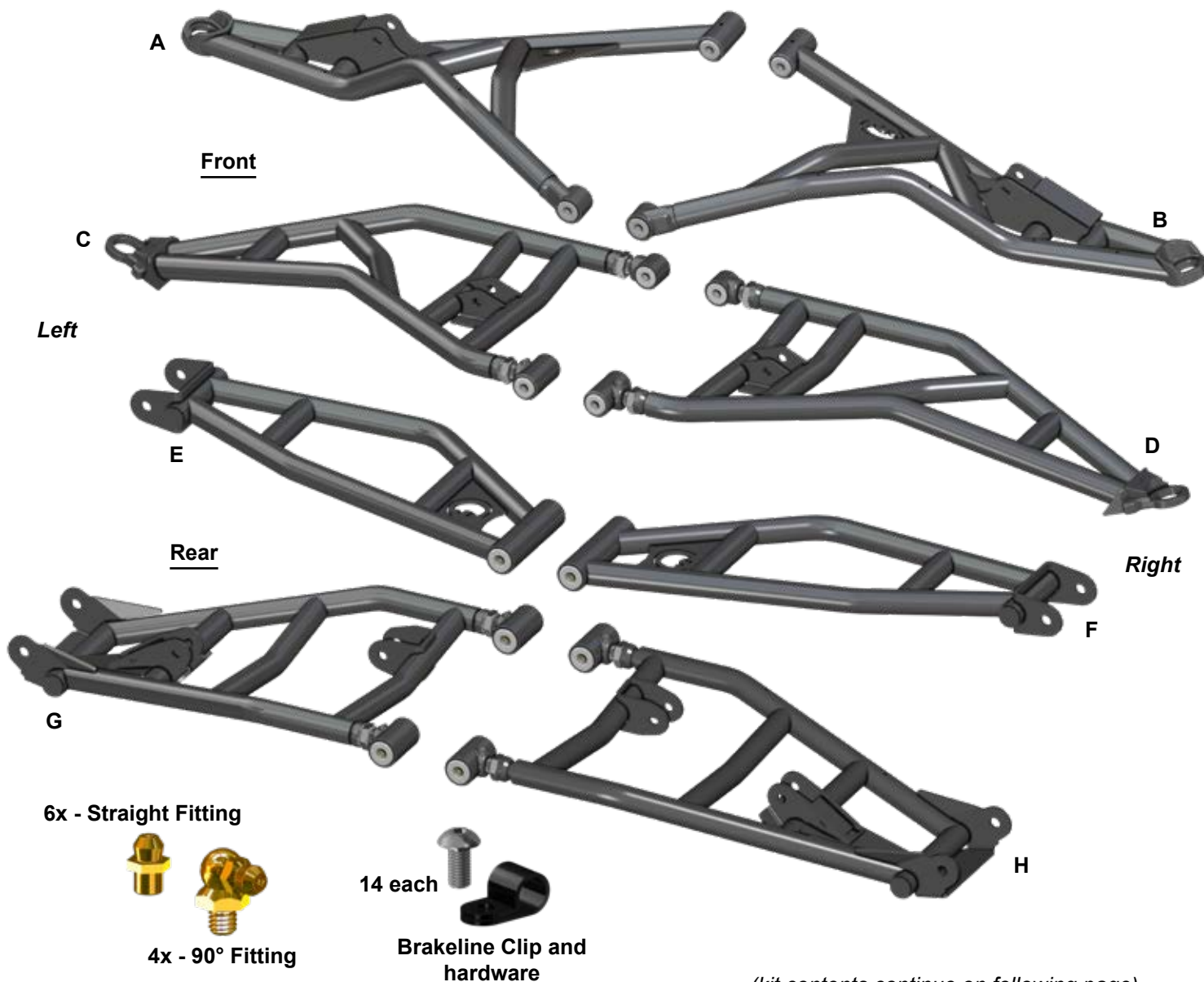

(kit contents continue on following page)

**Need help with your installation?**



sales@superatv.com



www.superatv.com



1-855-743-3427



8:00am - 8:00pm EST M-Th  
8:00am - 7:00pm EST Friday  
9:00am - 2:00pm EST Saturday

**Read instructions and view illustrations before beginning.**

*Thank You*

*For Choosing*

**SUPERATV**.COM<sup>®</sup>

(kit contents continued)



### Spring Kit

2 x Front



2 x Rear



**SKU LTK-P-XPD-4-002 DOES NOT INCLUDE A SPRING KIT**

***SuperATV strongly recommends using a Spring Compressor when removing and installing Springs.***

### Brake Lines

Location	Length (Approx)
Left Front	46-5/8"
Right Front	54-3/8"

***DURING INSTALL DO NOT TIGHTEN HARDWARE COMPLETELY UNLESS NOTED.***

#### Liability Statement

SuperATV's® products are designed to best fit user's ATV/UTV under stock conditions. Adding, modifying, or fabricating any factory or aftermarket parts will void any warranty provided by SuperATV® and is not recommended. SuperATV's® products could interfere with other aftermarket accessories. If user has aftermarket products on machine, contact SuperATV® to verify that they will work together.

Although SuperATV® has thousands of satisfied customers, user should be aware that installing lift kits, long travel, or suspension kits, tires, etc. will change the ride of machine and may increase maintenance and part wear. Operating any off-road machine while, or after, consuming alcohol and/or drugs increases risk of bodily harm or death. No warranty or representation is made as to this product's ability to protect user from severe injury or death. SuperATV® urges operators and occupants to wear a helmet and appropriate riding gear at all times.

By purchasing and installing SuperATV® products, user agrees that should damages occur, SuperATV® will not be held responsible for loss of time, use, labor fees, replacement parts, or freight charges. SuperATV®, nor any 3rd party, will not be held responsible for any direct, indirect, incidental, special, or consequential damages that result from any product purchased from SuperATV®. The total liability of seller to user for all damages, losses, and causes of action, if any, shall not exceed the total purchase price paid for the product that gave rise to the claim.

SuperATV® will warranty only parts provided by SuperATV®. Any damage or problems with OEM housings, bearings, seals, or other manufacturers' products will not be covered by SuperATV®. SuperATV® parts and products are not warrantied if item was not installed properly, misused, or modified.

Installing, adding, modifying, or fabricating any factory or aftermarket product to your ATV/UTV may violate certain local, state, and federal laws. Be advised that laws vary depending on town, city, county, state, etc. Use of certain products on public streets, roads, or highways may be in violation law. The Buyer is solely and exclusively legally and personally responsible for any violation of the law by the installation or use of the product. You must abide by all local, state, and federal laws, including but not limited to vehicle safety, traffic laws, and ordinances. It is your responsibility to know the laws and how they apply to you.

The Buyer is responsible to fully understand the capability and limitations of his/her vehicle according to manufacturer specifications, warnings and instructions and agrees to hold SuperATV® harmless from any damage resulting from failure to adhere to such specifications, warnings and/ or instructions. The Buyer is also responsible to obey all applicable federal, state, and local laws and ordinances when operating his/her vehicle while using this product, and the Buyer agrees to hold SuperATV® harmless from any violation thereof.

**Front Components Removal:** *Keep all components removed from machine.*

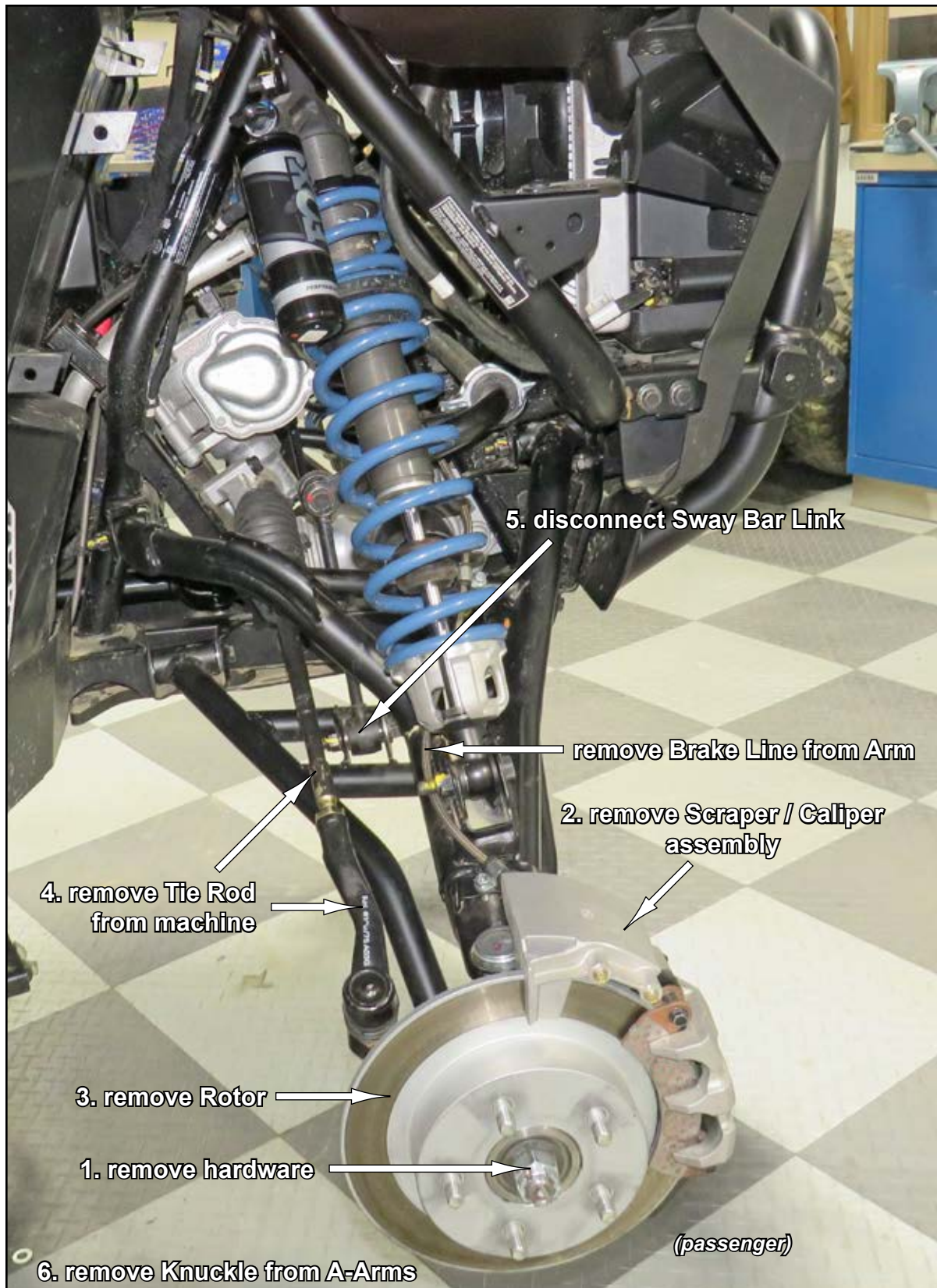

- Remove Shock, Axle, and A-Arms from machine.

repeat steps for driver side removal



**Rear Components Removal:** *Keep all components removed from machine.*



- Remove Shock, Axle, and A-Arms from machine.

repeat steps for passenger side removal

Install Ball Joints in directions shown.

stock Ball Joints



## FRONT PIVOT BLOCK SETTINGS

- Place new A-Arms onto a flat surface and verify dimension shown.
- *Negative 1° camber setting is achieved when Pivot Blocks are set to this dimension.*
- See last page for additional camber information.

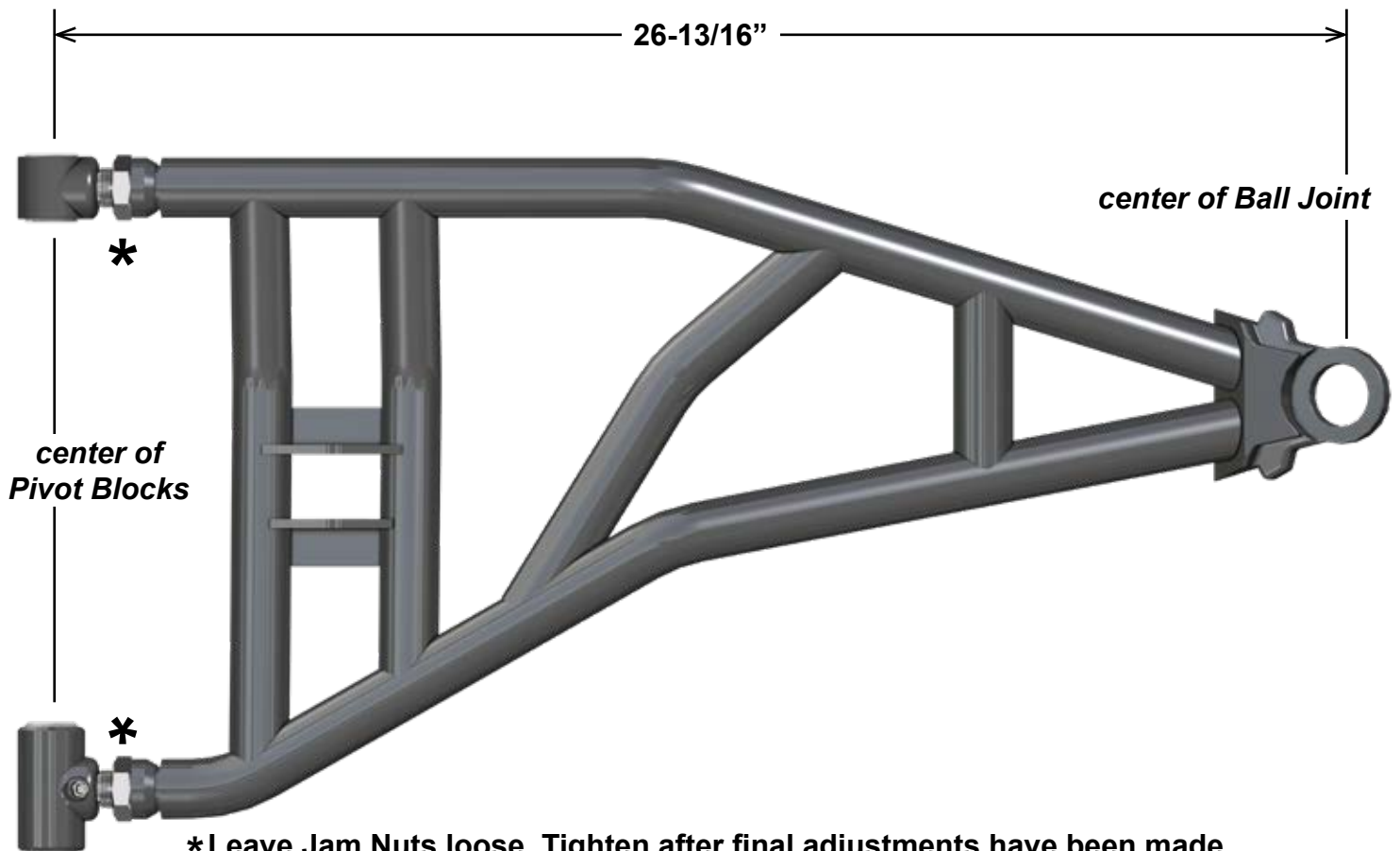

**\* Leave Jam Nuts loose. Tighten after final adjustments have been made.**

### **Front A-Arms Prep:**

- Install provided Fittings.
- Set aside.

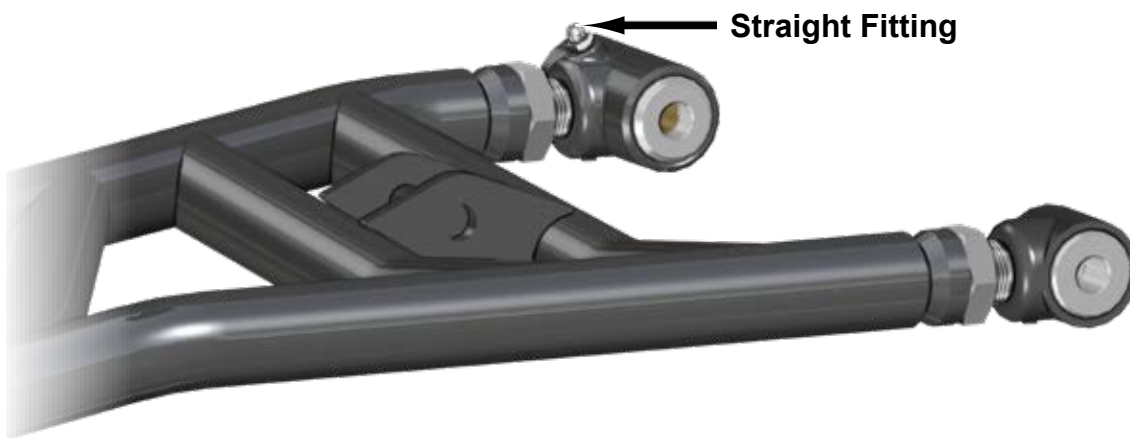



### Spring replacement:

- Place Shock into Spring Compressor and remove components shown.
- Install new Spring and reverse removal steps.
- Remove Shock and repeat steps for remaining Shocks.



### Front installation:

- Install new Front Axle.
- Install Lower - L (C) to Frame with stock hardware; **keep Nuts loose until all final adjustments have been completed and do not use Loc-Tite at this time.**
- Install Upper - L (A) to Frame with stock hardware; tighten. *SuperATV recommends using Loc-Tite on Nuts.*





**Front installation continued:**

- Install Knuckle, Rotor, and Scraper / Caliper assembly with stock hardware; ***Keep Knuckle to Lower - L (C) loose until all final adjustments have been completed.***
- Secure Axle with provided Axle hardware.



- Install Shocks to Upper - L (A) and Frame with stock hardware.
- Secure Sway Bar Link to Upper - L (A) with stock hardware.
- Tighten hardware.



**Front installation continued:**

- Secure Tie Rod to Knuckle; refer to IN-TRRA-P-XPD-4.



- Repeat steps for opposite side.
- Install and secure provided Brake Lines to Master Cylinder and Calipers.
- Secure to Arms with components shown; tighten.,



## REAR PIVOT BLOCK SETTINGS

- Place new A-Arms onto a flat surface and verify dimension shown.
- *Negative 1° camber setting is achieved when Pivot Blocks are set to this dimension.*
- See last page for additional camber information.

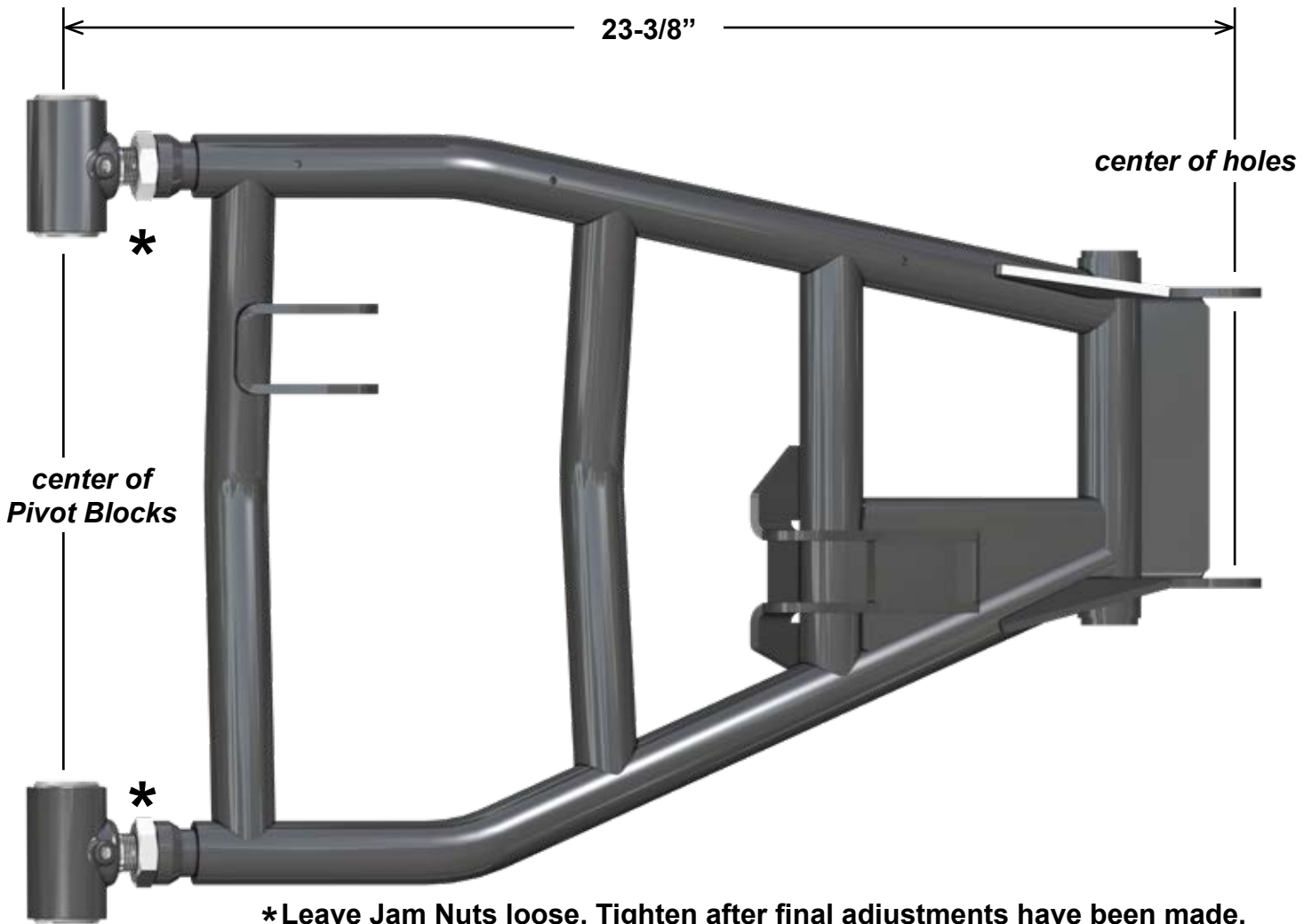



### **Rear A-Arms Prep:**

- Install provided Fittings.
- Set aside.

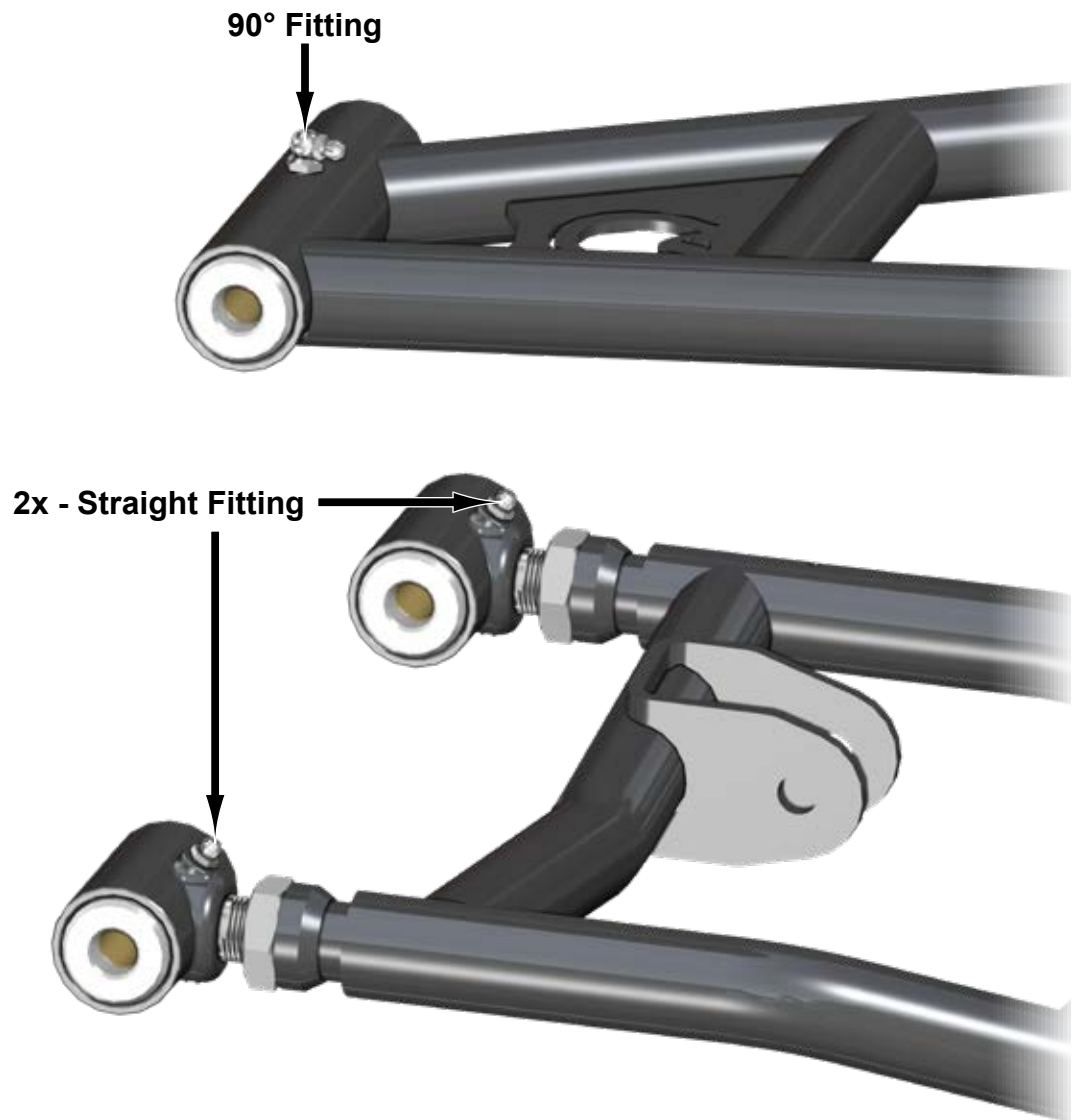

### Rear installation:

- Install new Rear Axle.
- Install Lower - L (G) to Frame with stock hardware; **keep Nuts loose until all final adjustments have been completed and do not use Loc-Tite at this time.**



### Rear installation continued:

- Install Shock to Frame with stock hardware; tighten.
- Install Upper - L (E) to Frame with stock hardware; tighten. *SuperATV recommends using Loc-Tite on Nut.*
- Secure Shock to Lower - L (G) with hardware shown; **keep Nut loose until all final adjustments have been completed.**

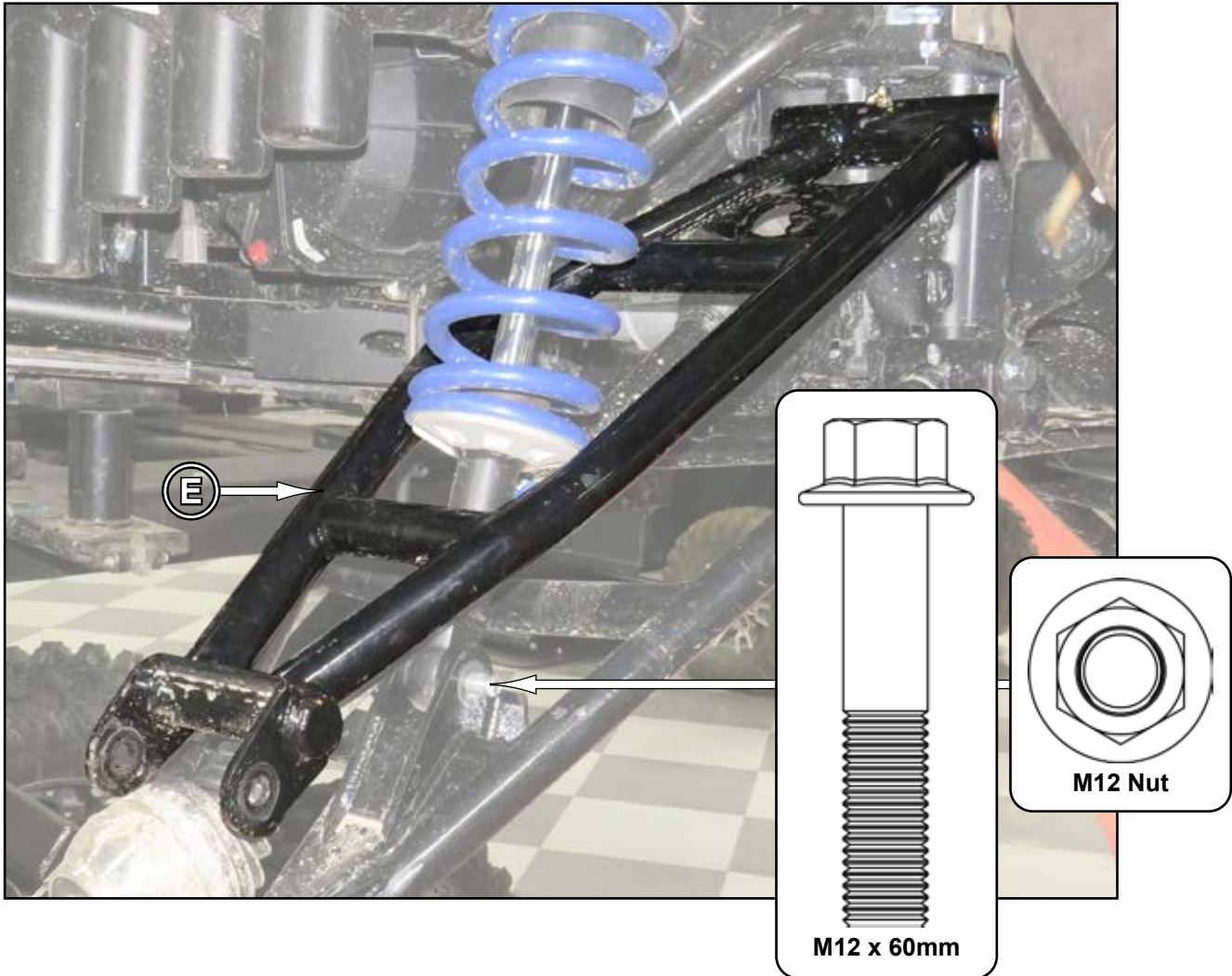



**Rear installation continued:**

- Install Knuckle, Rotor, and Scraper / Caliper assembly with stock hardware; ***Keep Knuckle to Lower - L (G) loose until all final adjustments have been completed.***
- Secure Axle with provided Axle hardware.



- Secure Sway Bar Link to Lower - L (G) with stock hardware; **keep Nut loose until all final adjustments have been completed.**
- Repeat steps for opposite side.
- Reinstall Tires and check Camber settings; see following page.
- Tighten all loose Nuts. SuperATV recommends using Loc-Tite on Nuts.

- Secure Brake Lines with components shown.

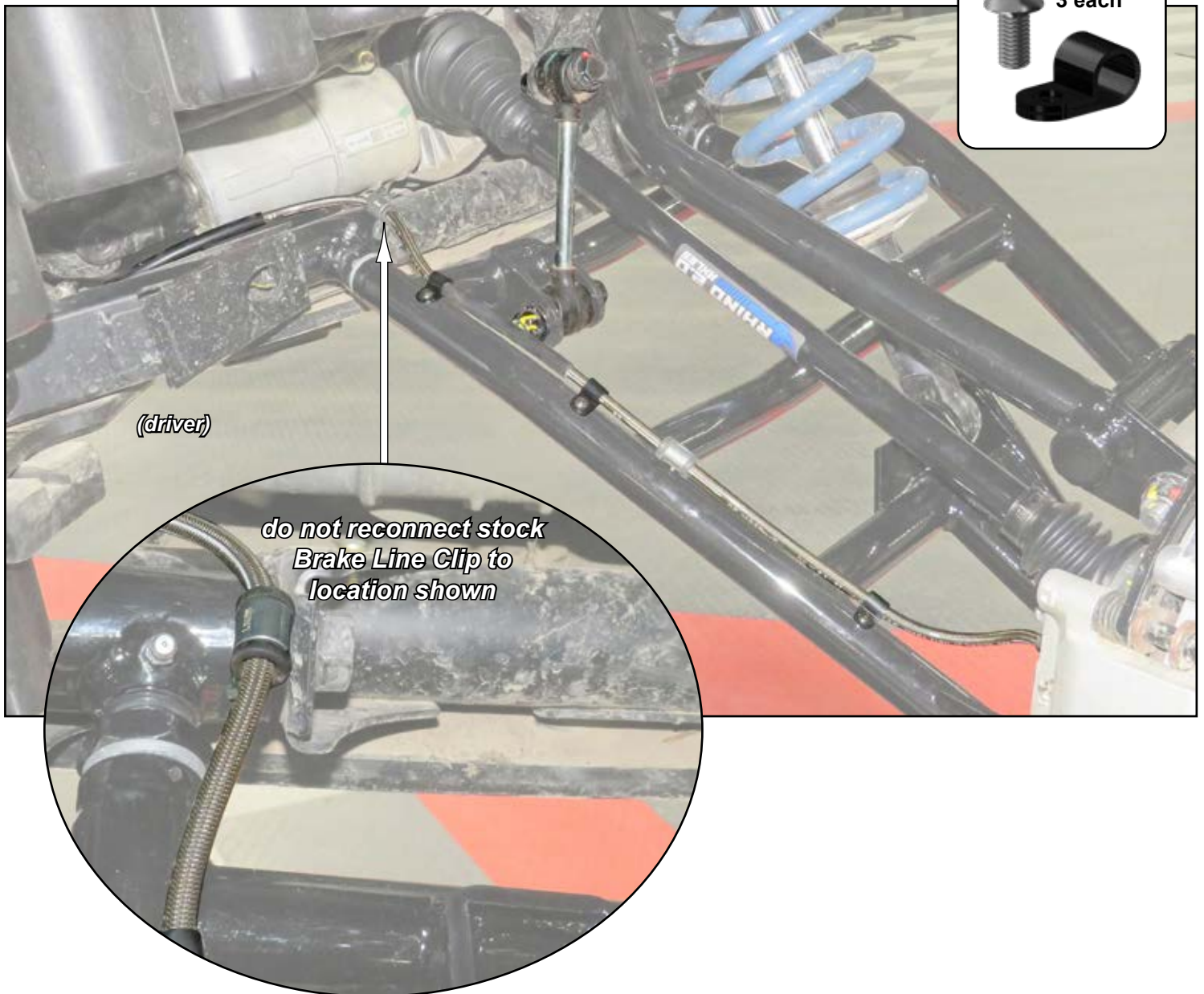



## CAMBER

- Tires must have equal air pressure before making adjustments.
- Adjustments to be made after all suspension components have been completely assembled.
- Tires must not be in contact with ground when making adjustments.
- Perform adjustments in small increments.



### Adjusting Camber:

- Remove A-Arms from Frame and turn Pivot Blocks to adjust camber. Reinstall Arms.
- Lower machine and settle suspension components by rolling machine back and forth several feet at a time.
- Check settings and make small adjustments as needed.
- Each time an adjustment is made, machine must be rolled back and forth to settle suspension components.
- Once desired setting is achieved, tighten hardware completely. Loc-tite on Nuts is recommended.

**A NEGATIVE CAMBER SETTING OF 1° to 2° IS RECOMMENDED.**

### LOWER:

Too much positive camber: adjust Pivot Blocks **OUT**.

Too much negative camber: adjust Pivot Blocks **IN**.

*note: 2 full turns is 1°*

### UPPER A-ARMS:

Too much positive camber: adjust Pivot Blocks **IN**.

Too much negative camber: adjust Pivot Blocks **OUT**.

*note: 2 full turns is 1°*

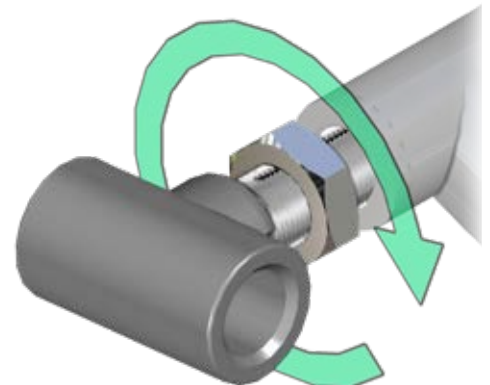



## Billet Tie Rod Kit

Do not discard packaging until product has been successfully installed.



2 x Boot



4 x Zip Tie

*SuperATV logo will signify left hand threaded end of Shaft.*



2 x Tie Rod Shaft



Hardware Kit



2 x Ball and Socket

2 x Tie Rod End and Jam Nut



### CUSTOMER NOTIFICATION AND DISCLAIMER LIABILITY

**This product is a modification for utility task vehicles and all terrain vehicles. Use this product at your own risk.**

**Warranty and Liability Limitations.** The Buyer hereby assumes all risks associated with the use and/or installation of this product. Buyer waives all liability claims against SuperATV<sup>®</sup> of any kind or nature, including, but not limited to, liability for penalties, fines, property damage, personal injury or death, to the fullest extent permitted by law. Buyer acknowledges and agrees that SuperATV<sup>®</sup> is not liable for any direct, indirect, incidental, consequential or special damages, including but not limited to, damage, loss of life, loss of property or equipment, loss of profits or revenue, injury, or claims from any individual or entity arising from the use of this product.

The warranty for this product, if any, may give you ("Buyer") specific legal rights, and Buyer may also have other rights which may vary from state to state. The installation of this product may void or otherwise adversely affect your factory warranty.

Consult your vehicle warranty before using this Product. Under no circumstances will SuperATV<sup>®</sup> be liable for the voidance of the Buyer's vehicle warranty. Buyer assumes all risk and responsibility if a manufacturer and/or dealer voids the Buyer's vehicle warranty due to use of this Product.

**Safety and Laws.** Operate your vehicle at all times in a safe manner. You must abide by all local, state, and federal laws, including but not limited to vehicle safety, traffic laws, and ordinances. It is your responsibility to know the laws and how they apply to you. The installation of this product may violate certain local, state, and federal laws. Be advised that laws vary depending on town, city, county, state, etc. Use of this product on public streets, roads, or highways may be in violation law. The Buyer is solely and exclusively legally and personally responsible for any violation of the law by the installation or use of this product. In no case will SuperATV<sup>®</sup> be held liable if Buyer violates the law or uses the product in an unsafe manner.

The Buyer is responsible to fully understand the capability and limitations of his/her vehicle according to manufacturer specifications, warnings and instructions and agrees to hold SuperATV<sup>®</sup> harmless from any damage resulting from failure to adhere to such specifications, warnings and/ or instructions. The Buyer is also responsible to obey all applicable federal, state, and local laws when operating his/her vehicle while using this product, and the Buyer agrees to hold SuperATV<sup>®</sup> harmless from any violation thereof.

**Installation.** The installation of this product on your vehicle indicates that you have had the opportunity to inquire about applicable local, state, and federal laws and ordinances and that you have read and understand, and accept all of the terms of, this Disclaimer.

SuperATV<sup>®</sup> shall not be responsible for the proper installation, use, and service of this product. Rather, the Buyer shall be solely responsible for the installation of the product and any damage that may be done to the vehicle or vehicle components as a result of modifications made by the Buyer.

### Need help with your installation?



sales@superatv.com



www.superatv.com



1-855-743-3427



8:00am - 8:00pm EST M-Th  
8:00am - 7:00pm EST Friday  
9:00am - 2:00pm EST Saturday

### Read instructions and view illustrations before beginning.

*Thank You*

*For Choosing*

**SUPERATV**.COM<sup>®</sup>

- Install Ball and Sockets to Rack and Pinion. Use provided Bonding Adhesive.
- Install Boots to Rack and Pinion and secure with provided Zip Ties. Use a lubricant to ease installation.
- Secure Boots to Ball and Sockets with provided Zip Ties.
- Install Jam Nuts to Ball and Sockets.
- Install Tie Rod Shafts to Ball and Sockets.
- Install Tie Rod Ends and Jam Nuts to Tie Rod Shafts.
- Secure Tie Rod Ends to same location as stock on Spindles with hardware shown.

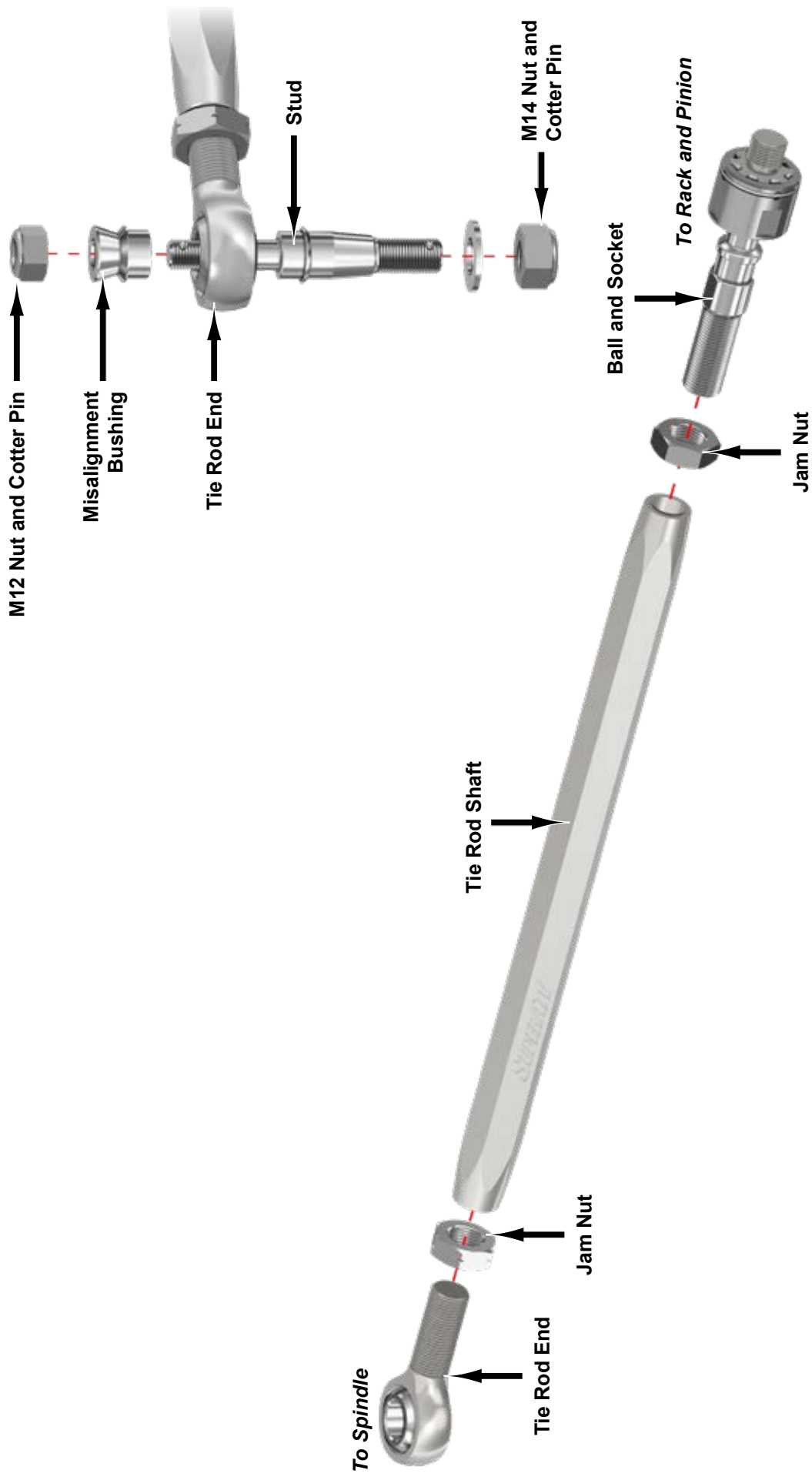

- Set toe of vehicle.
- Loosen Jam Nuts and apply Bonding Agent to Tie Rod End threads and Ball and Socket threads.



apply Bonding Agent to locations shown and retighten Jam Nuts

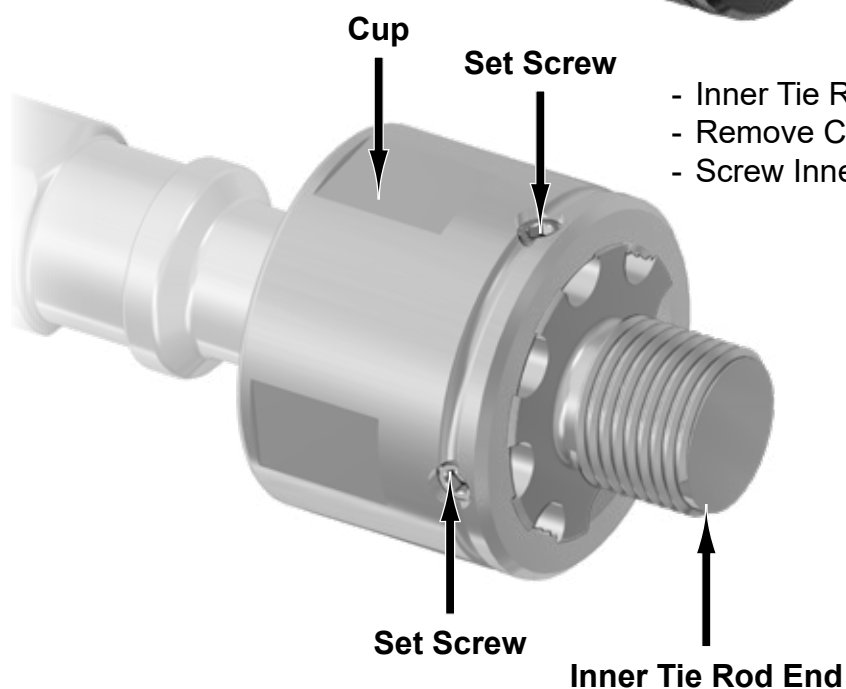

- Inner Tie Rod End is adjustable and can be tightened.
- Remove Clip and loosen (4) Set Screws
- Screw Inner Tie Rod End into Cup.